



NOTICE OF POTENTIAL ANNEXATION OF TERRITORY EXPEDITED ANNEXATION

The City of Lake Oswego has received an annexation petition for one parcel, shown on the attached map, which is located within the Urban Service Boundary of the City of Lake Oswego. The parcel is located at:

13485 Atwater Lane (21E04AC01800)

The proposed annexation will be considered by the City Council on **Tuesday, July 3, 2018 at 6:30 p.m.** in the City Hall Council Chamber, 380 A Avenue, Lake Oswego. This application is being reviewed under Metro Code 3.09.045 "Expedited Decisions" and there will be no public hearing unless a necessary party provides written notice of its objection to the boundary change.

Annexations are adopted by ordinance. The title of the ordinance is:

Ordinance 2789

An ordinance annexing to the City of Lake Oswego one parcel consisting of 0.96 acres at 13485 Atwater Lane; declaring City of Lake Oswego zoning pursuant to LOC 50.01.004.5(a-c); and removing the territory from certain districts (AN 18-0005).

APPLICABLE CRITERIA:

1. Oregon Revised Statutes, Boundary Changes; Mergers and Consolidations
 - ORS 222.111(2) Annexation of Contiguous Territory, Authority and procedure for annexation, generally.
 - ORS 222.125 Annexation by consent of all owners of all of the land in the area to be annexed and not less than 50% of the registered voters living in the area.
2. Metro Code
 - 3.09.040(a)(1-4) Minimum Requirements for Petitions.
 - 3.09.045 Expedited Decisions
 - Lake Oswego Community Development Code
 - Section 50.05.009.4 Zoning of Annexed Areas
 - Section 50.01.004.5 Comprehensive Plan Map Designations Automatically Applied Upon Annexations; Exceptions.
3. Lake Oswego Comprehensive Plan - Urbanization Chapter
 1. Policy A-3: "The Urban Services Boundary (as depicted on the Comprehensive Plan Map) is the area within which the City shall be the eventual provider of the full range of urban services."
 2. Policy C-3: "Ensure that annexation of new territory or expansion of Lake Oswego's Urban Services Boundary does not detract from the City's ability to provide services to existing City Residents."
 3. Policy C-4: "Prior to the annexation of non-island properties, ensure urban services are available and adequate to serve the property or will be made available in a timely manner by the City or a developer commensurate with the scale of the proposed development."

The Applicants are requesting annexation to obtain City services. In accordance with LOC 50.01.004.5, the City zoning designation of R-10 (10,000 square feet per unit) shall be applied to this property. Permitted and conditional uses in these zones can be found in LOC 50.03.002.

Copies of the petition, all documents and evidence submitted by or on behalf of the applicant, applicable criteria, map and proposed Ordinance 2789 are available for inspection at no cost. The staff report will be available for review seven days before the hearing and a copy will also be available for review at the Lake Oswego Library in the "Reference" section. Copies will be provided at reasonable cost. To inspect or purchase copies of the above documents, please visit City Hall at 380 A Avenue, Lake Oswego.

Information on this application is also available at:

<https://www.ci.oswego.or.us/planning/18-0005-13485-atwater-lane>

Inquiries regarding the proposal may be directed to Paul Espe, Associate Planner, at (503) 697-6577.

For information about the City Council meeting, contact Anne-Marie Simpson, City Recorder, (503) 534-4225.

Please refer to file AN 18-0005, (proposed Ordinance 2789).

Date Mailed: June 13, 2018.

**Annexation to the City of Lake Oswego
AN18-0005/Ordinance 2789**

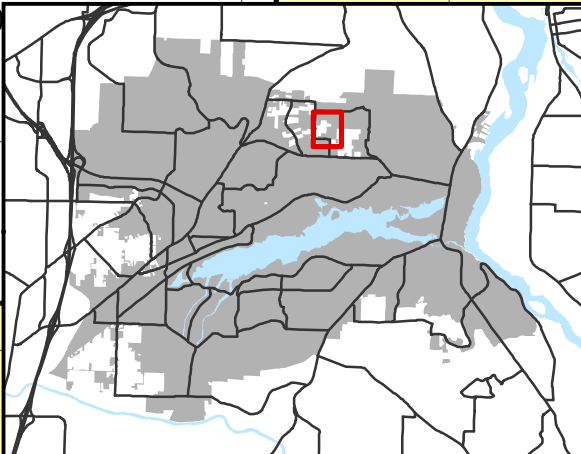
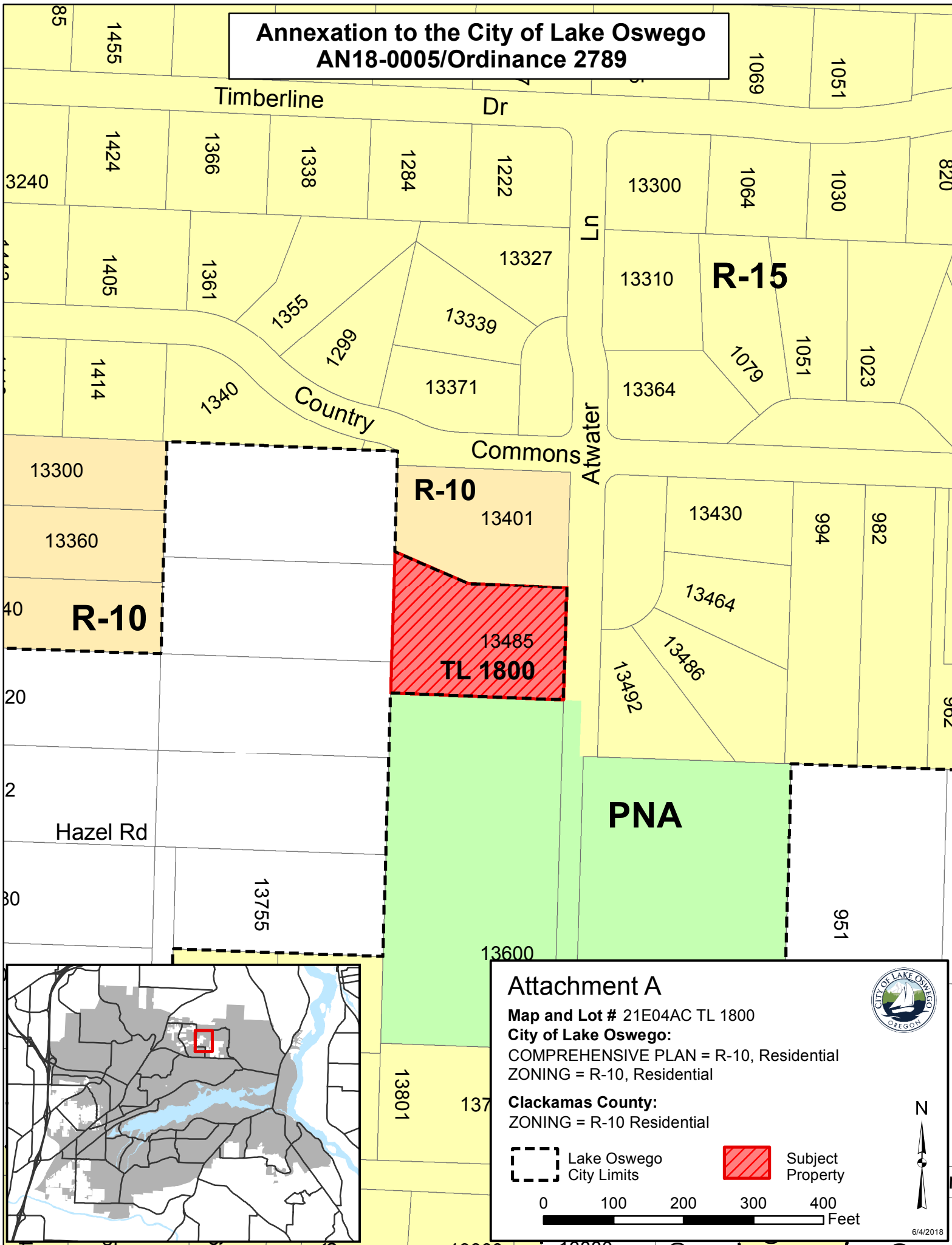



Attachment A

Map and Lot # 21E04AC TL 1800

City of Lake Oswego:
 COMPREHENSIVE PLAN = R-10, Residential
 ZONING = R-10, Residential

Clackamas County:
 ZONING = R-10 Residential

 Lake Oswego City Limits
  Subject Property

0 100 200 300 400 Feet

 N

6/4/2018