



Permit No.: _____
 Date: _____
 Site Visit: _____
 Intake Staff: _____

Invasive Tree Removal Application

Property Owner: _____ Applicant: _____

E-mail (required) _____ Phone: _____

Address of Tree Removal: _____

I grant permission to City employees and City consultants to enter the above property to verify species of trees requested for removal and to inspect mitigation (if required). I agree to restrain any dog(s) on inspection day. Right of entry expires with the issuance of the permit or when mitigation is inspected and approved.

Signature of Property Owner (Required)

1. Species, Number, and Size of Invasive Tree(s) to be Removed:

<input checked="" type="checkbox"/>	Common Name	Species Name*	Number	Size**
<input type="checkbox"/>	Norway maple	<i>Acer platanoides</i>		
<input type="checkbox"/>	sycamore maple	<i>Acer pseudoplatanus</i>		
<input type="checkbox"/>	tree-of-heaven	<i>Ailanthus altissima</i>		
<input type="checkbox"/>	European white birch	<i>Betula pendula</i>		
<input type="checkbox"/>	English hawthorn	<i>Crataegus monogyna</i>		
<input type="checkbox"/>	English holly	<i>Ilex aquifolium</i>		
<input type="checkbox"/>	princess tree	<i>Paulownia tomentosa</i>		
<input type="checkbox"/>	white poplar	<i>Populus alba</i>		
<input type="checkbox"/>	sweet cherry	<i>Prunus avium</i>		
<input type="checkbox"/>	black locust	<i>Robinia pseudoacacia</i>		
<input type="checkbox"/>	European mountain ash	<i>Sorbus aucuparia</i>		
<input type="checkbox"/>	Siberian elm	<i>Ulmus pumila</i>		

2. Are any of the trees located in public rights-of-way or a Resource Protection Area? No
 Or, were any of the trees planted as part of an approved landscaping or mitigation plan? Yes, quantity _____

3. Attach a site plan of the property depicting the approximate location of each tree to be removed and proposed mitigation (if applicable).

4. Attach site photographs clearly identifying each species of tree to be removed.

***For assistance with species identification, call (503) 635-0290 to request an Invasive Tree ID Guide.**

****Trunk diameter measured in inches at 4.5-feet above ground level.**

Mitigation Required: No ___ Yes ___ Conditions of Approval:

Respect. Excellence. Trust. Service.

SITE PLAN EXAMPLE FOR A TREE REMOVAL APPLICATION

A site plan is required as part of your tree removal request. The site plan must be on 8.5" x 11" size paper.

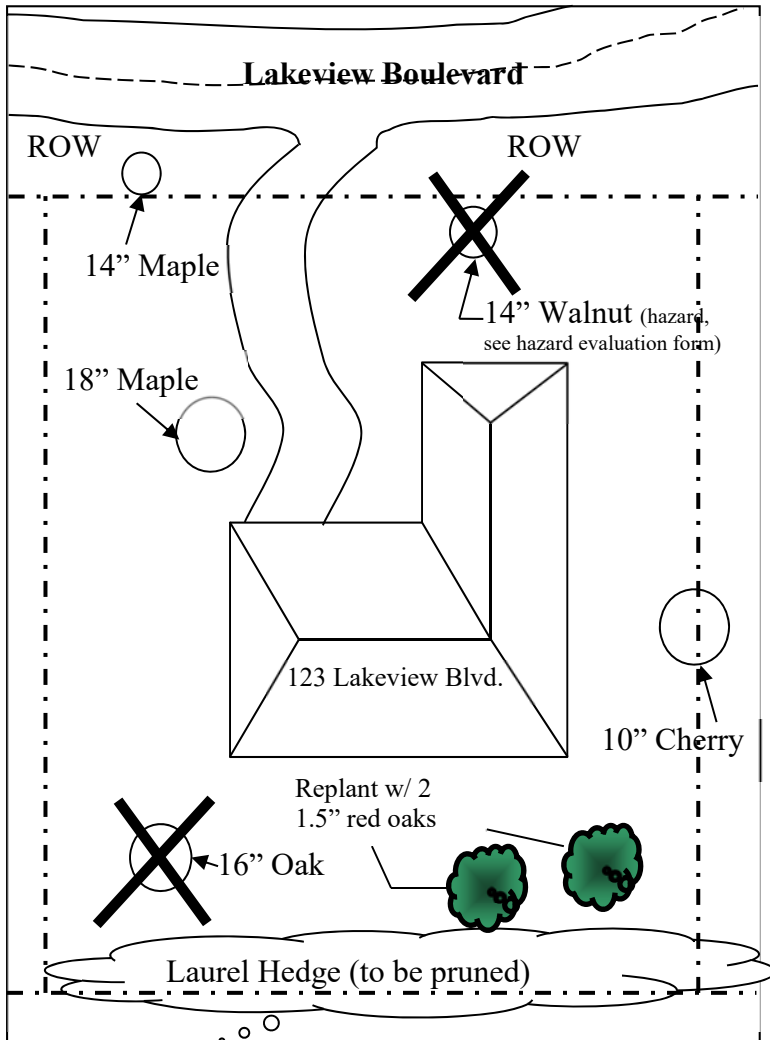

ITEMS TO INCLUDE ON YOUR SITE PLAN:

- Your **property lines**
- Address** of the Tree Removal Site
- Public **Right Of Way** (Include Street Name)
- House or other **Structures** (Mark "Vacant" if none)
- Creeks, Streams, or Lake** that run through or border property
- Location, Diameter Size and Type of Trees** proposed for removal; **mark trees** to be removed with an "X"
- Proposed replacement trees** for TYPE II tree permits [1:1 minimum required, 1.5" minimum caliper size for deciduous trees, 6-ft. minimum height for evergreens]

Mitigation trees are required for ALL Type II removal permits. The mitigation trees will be a condition of approval for a tree removal permit.

Within 24 hours of submitting your application, mark the tree(s) with yellow ribbon, post the sign, and stake building corners (if new construction is proposed). If trees are not marked or the sign is not posted as required, the comment period may be restarted.

TREE REMOVAL IN THE RIGHT-OF-WAY / TREE WORK IN RIGHT-OF-WAY

If trees are being removed in the right-of-way, or tree work will be occurring in the right-of-way you must first obtain a Traffic Control Permit.

All activities within the public right-of-way require an approved traffic control permit from the City of Lake Oswego. The purpose of a Traffic Control Plan is to allow a contractor to legally work within the public right-of-way efficiently and effectively while maintaining a safe, uniform flow of traffic.

There is no fee for a traffic control permit and a permit must be obtained before commencing any work in the public right-of-way: <https://www.ci.oswego.or.us/FormsLF/TTCPApplication>.