

CITY OF LAKE OSWEGO CULTURAL RESOURCES INVENTORY FIELD FORM 1988-1989

HIST. NAME: Collard, F.A., House
DATE OF CONSTRUCTION: c. 1860
COMMON NAME:
ORIGINAL USE: Residence
ADDRESS: 880 Bickner Street
OWNER: Fischer, Julie M.
PRESENT USE: Residence
ARCH./BLDR.: Unknown
T/R/S: 2S 1E 10DB
TAX LOT: 7900

STYLE: Vernacular
RESOURCE TYPE:
Building
THEME: Architecture;
Settlement;
Agriculture
ADDITION: South
Oswego
BLOCK: 10
LOT: 5, 6
QUAD: Lake Oswego
LOT SIZE: .23
ZONE: R-7.5

PLAN TYPE/SHAPE: T-plan
NO. OF STORIES: 2
FOUNDATION MATERIAL: Concrete
BASEMENT: Yes
ROOF FORM & MATERIALS: Intersecting gable; wood shingle

WALL CONSTRUCTION: Wood
STRUCTURAL FRAME: Unknown
PRIMARY WINDOW TYPE: Four-over-four double-hung sash w/modest architrave molding
EXTERIOR SURFACING MATERIALS: Shiplap w/rake and cornerboards
DECORATIVE FEATURES: Jigsawn porch brackets

OTHER: Full-width hip-roof porch supported by chamfered posts
with decorative brackets

CONDITION: Good

EXTERIOR ALTERATIONS/ADDITIONS: Doors replaced (n.d.); chimney replaced, (n.d.); front porch deck (and probably balustades) removed (n.d.); shutters added, (n.d.); attached garage added on n. elevation (n.d.); brick patio and walkway in sideyard (n.d.)

NOTEWORTHY LANDSCAPE FEATURES: Numerous old fruit trees to west of house; functioning well; massive Laurel hedge borders south property line

ASSOCIATED STRUCTURES: Large out building to southwest of house has gabled roof with composition shingles; gabled wall dormer; board and batten siding; small multi-light windows shed dormer

SETTING: Located on northwest corner of Oak and Bickner Streets in residential area characterized by historic period dwellings; 2.5 blocks east of McVey Avenue, a heavily trafficked thoroughfare; neighborhood has limited public improvements -- few sidewalks and several vacated streets;

NOTES:

RECORDER(S): Koler/Morrison
SHPO #: 340

DATE: January 1989
FIELD #: 101

CITY OF LAKE OSWEGO CULTURAL RESOURCES INVENTORY

ADDRESS 880 BICKNER ROAD
TAXMAP/LOT. 2S 1E 10DB/7900
SHPO# _____ ROLL/FRAME# _____

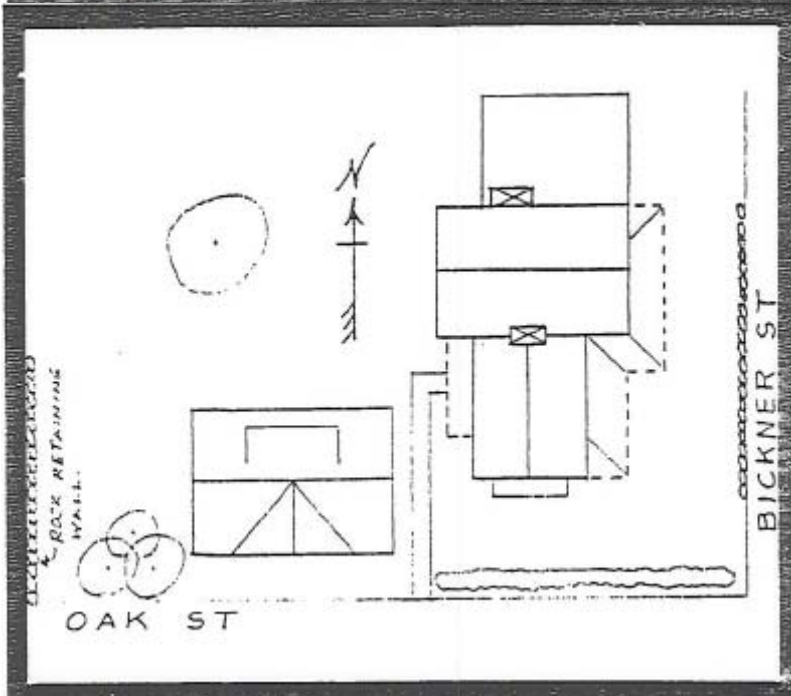

STATEMENT OF SIGNIFICANCE

Address: 880 Bickner Street
Historic Name: Collard, F.A., House

According to a former owner, this house, built circa 1860, may have been the original residence on the Donation Land Claim of the F.A. Collard family.

The property was owned by John Bowle from 1889 to 1907 when he died. Born in Virginia in 1826, Bowle traveled to Oregon and Oswego in 1853. For the remainder of the historic period the house belonged to Pressley and Flora Jarisch. Pressley Jarisch was brother-in-law to Albert Walling who obtained a Donation Land Claim in the Oswego area. Jarisch first came to Oswego in 1880 to haul wood to make charcoal for the Oregon Iron Company. Jarisch and Albert Walling had a 200-acre nursery for 25 years, shipping trees and other stock all over the world. The partners sold their land finally to Marylhurst College for \$34,000. Walling and Jarisch married sisters, Flora and Mary Bagby of Molalla. Flora Jarisch died shortly before the house was purchased in 1937 by the Lowry family.

Mr. and Mrs. H.H. "Jerry" Lowry, who purchased the house in 1947, found a newspaper, under ten layers of wallpaper. The paper mentioned firing on Fort Sumter and the first operation against Vicksburg in the Civil War. The Lowrys did extensive work on the house making all repairs, changes and additions in keeping with the integrity of the original structure. H.H. Lowry is listed in the 1947-48 Clackamas County Directory as a salesman for the Columbia Co. in Portland.

The Collard House is an excellent example of the Vernacular style. Characteristic features include the two-story T-plan, finished with horizontal lap siding with corner and rake boards, and four-over-four double-hung sash windows. The full-width porch is also typical of the style. The jigsaw brackets and chamfered posts appear to be original. These types of ornamental features are rarely found on houses in this area due in part to the wet climate which is quick to cause deterioration.

The house is significant for its association with the Collard family as well as a fine example of the Vernacular building type. The house is also important as one of the oldest houses in the South Town area.

Bibliography: Clackamas County Cultural Resource Inventory, Department of Transportation and Development, 1984. Clackamas County Directory, 1947-48.
Fischer, Julie. Unrecorded Interview with N. Babcock, 10/25/88.
"Home Is Their House," Oregon Journal, N.W. Living Magazine, 9/20/59.
Oregon Daily Journal, P. H. Jarisch, "Oswego Resident for over 50 Years--His Own Account," 6/29/33, p. 10.
Ticor Title Company, Oregon City, OR.