

CITY OF LAKE OSWEGO CULTURAL RESOURCES INVENTORY FIELD FORM 1988-1989

HIST. NAME: Tug Master's House
DATE OF CONSTRUCTION: 1905
COMMON NAME:
ORIGINAL USE: Residence
ADDRESS: 107 Burnham Road
OWNER: Johansen, Kirk, Same
PRESENT USE: Residence
ARCH./BLDR.: Unknown
T/R/S: 2S 1E 11CC
TAX LOT: 100

STYLE: Craftsman
RESOURCE TYPE:
Building
THEME: Architecture;
Industry
ADDITION: N/A
BLOCK:
LOT:
QUAD: Lake Oswego
LOT SIZE: .5 Acre
ZONE: R-15

PLAN TYPE/SHAPE: Asymmetrical
NO. OF STORIES: 2
FOUNDATION MATERIAL: Concrete
BASEMENT: Yes, raised
ROOF FORM & MATERIALS: Truncated hip w/intersecting gable; deep eaves; composition shingles

WALL CONSTRUCTION: Wood
STRUCTURAL FRAME: Stud .
PRIMARY WINDOW TYPE: Double-hung sash
EXTERIOR SURFACING MATERIALS: Narrow bevel w/corner and frieze boards
DECORATIVE FEATURES: None

OTHER: Full-width front porch w/ Tuscan columns; paneled and glazed door; paired French doors; porch deck extended to path from driveway
CONDITION: Good
EXTERIOR ALTERATIONS/ADDITIONS: Basement converted to living space (n.d.)
NOTEWORTHY LANDSCAPE FEATURES: Mature coniferous trees and ornamental plantings
ASSOCIATED STRUCTURES: Garage

SETTING: Located on steep, heavily wooded slope overlooking Willamette River to east; *surrounding area* characterized by recently constructed residential subdivision
NOTES:

RECORDER(S): Koler/Morrison
SHPO #: 376

DATE: January, 1989
FIELD #: 175

CITY OF LAKE OSWEGO CULTURAL RESOURCES INVENTORY

ADDRESS 107 BURBRAM ROAD

TAX MAP/LOT 2S IE 11CC/100

51-IPO# _____ ROLL/FRAME# _____

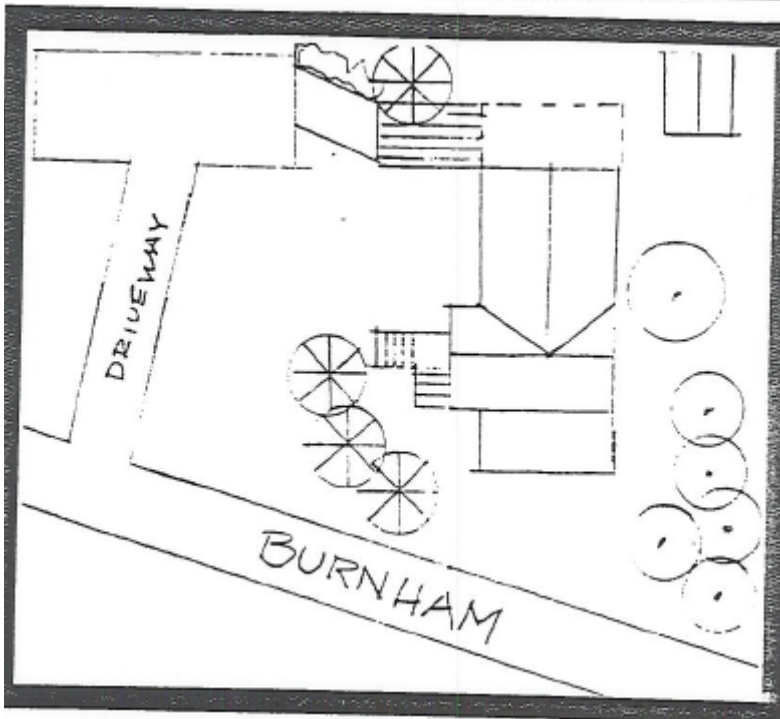

STATEMENT OF SIGNIFICANCE

Address: 107 Burnham Road

Historic Name: Tug Master's House

This Craftsman style home was built circa 1905 by Crown Willamette Paper Company (now known as James River Corporation) to house the log hoist and tug boat manager.

Rube Confer, manager, and his brothers Harry, John, Ed and Sy all lived in the house along with his parents and a sister. Rube and Sy both worked with the log hoist (see 16500 S. Old River Road) until the late 1920's when the operation shut down. Later Rube Confer ran a "donkey", remembers Roy Headrick, a friend and workmate. "This 'donkey' is a big steam thing that he built a fire in to pull the boats up over the rapids. There were these terrific rapids right below Oregon City. Rube gave me two blasts on his whistle on the donkey when the boat was ready to slide in so I could run over the hill to the river and watch it go in. This way they got the boats into the Willamette."

Tucked between Glenmorrie and the Willamette River, this house sits on the eastern edge of South Town, one of the earliest neighborhoods in Oswego. Platted in 1883 by Matthew and Catherine Patton, the area was popular with many iron worker families, as well as those serving other professions.

The Tug Master's House is a very good example of the Craftsman style of architecture, which in Oregon takes two forms. One type employs details which appear handcrafted; the other incorporate classically inspired features such as those seen on the subject property. The latter type usually has boxed eaves, while the former generally has exposed rafters or purlins, braces and bargeboards.

Alterations have not compromised the integrity of the building and, in fact, they are quite sensitively designed and executed. The landscape materials and garage also contribute to the historic character of the property.

Bibliography: Clackamas County Cultural Resource Inventory, Department of Transportation and Development, 1984, #57.
Headrick, Roy, Recorded Interview for "In Their Own Words," oral history for Lake Oswego Library, 1974