

**CITY OF LAKE OSWEGO
CULTURAL RESOURCES INVENTORY
FIELD FORM 1988-1989**

HIST. NAME: Parelus, Kenneth, House
DATE OF CONSTRUCTION: 1939
COMMON NAME:
ORIGINAL USE: Residence
ADDRESS: 768 North Shore Road
OWNER: Johnson, G.F.
PRESENT USE: Residence
ARCH./BLDR.: Sundeleaf, *Richard*
T/R/S: 2S 1E 10BA
TAX LOT: 7900

STYLE: Arts & Crafts
RESOURCE TYPE:
Building
THEME: Architecture
ADDITION: Lakewood
Plat No.2
BLOCK:
LOT: 319
QUAD: Lake Oswego
LOT SIZE:
ZONE: R-7.5

PLAN TYPE/SHAPE: L-Plan
NO. OF STORIES: 2
FOUNDATION MATERIAL: Concrete
BASESIENT: Unknown
ROOF FORM & MATERIALS: Gable with cross gable and dormers, cedar shingles

WALL CONSTRUCTION: Wood
STRUCTURAL FRAME: Stud
PRIMARY WINDOW TYPE: Multi-light casement
EXTERIOR SURFACING MATERIALS: Stucco, Cedar beveled siding
DECORATIVE FEATURES: Plank entry door; large acorn drops at living room wing; curved roof over rear porch

OTHER: None
CONDITION: Good
EXTERIOR ALTERATIONS/ADDITIONS: Minor extension of garage, (n.d.)
NOTEWORTHY LANDSCAPE FEATURES: Extensive rock walls, mature trees
ASSOCIATED STRUCTURES: None

SETTING: Adjacent to North Shore Blvd. bridge at end of Lakewood Bay; lake front property surrounded by newer homes on small lots
NOTES:

RECORDER(S): Mackenzie, Koler/Morrison DATE: February 1989
SHPO #: 357 FIELD #: 93

CITY OF LAKE OSWEGO CULTURAL RESOURCES INVENTORY

ADDRESS 768 NORTH SHORE ROAD
TAX MAP/LOT 2S 1E 10BA/7900
SHPO# _____ ROLL/FRAME# _____

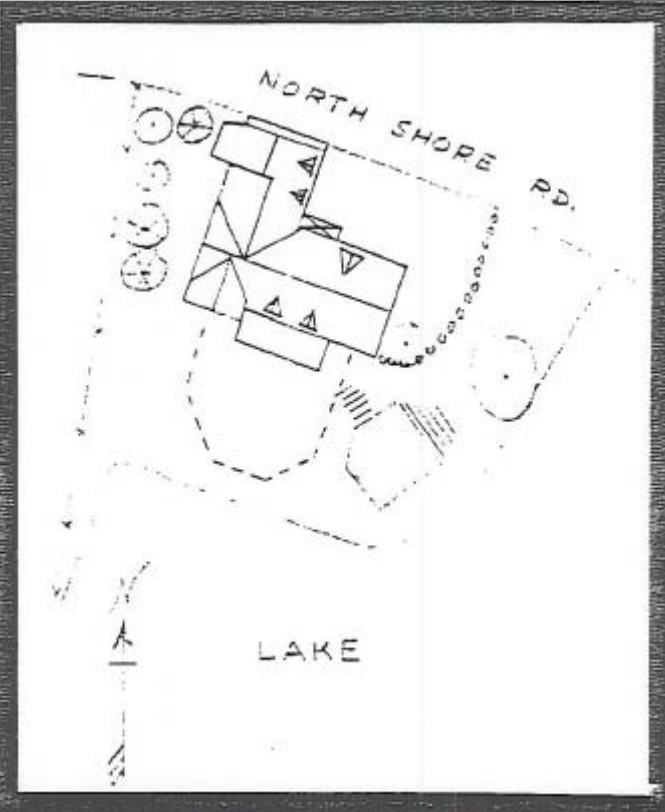
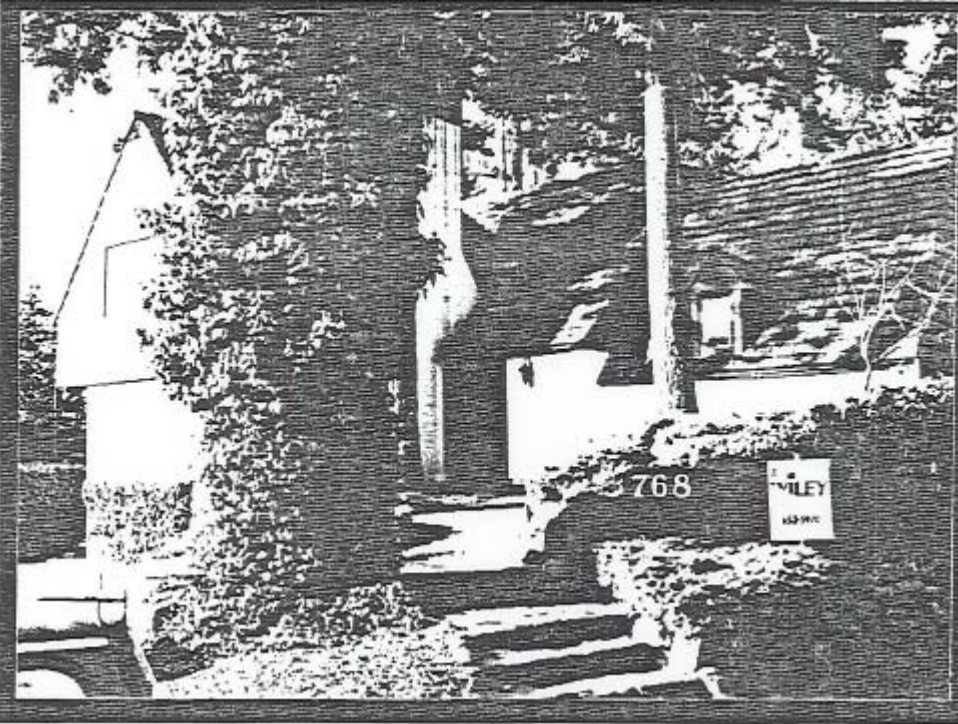

STATEMENT OF SIGNIFICANCE

Address: 768 North Shore Road

Historic Name: Parelius, Kenneth, House

This Arts and Crafts style house was built in 1939 for Kenneth and Viola Parelius. Parelius operated the Ford dealership in Lake Oswego before World War II. Besides his activities with various car dealerships around Portland, Parelius was involved in restaurants, real estate and life insurance. They sold the property in 1949 to Arthur and Helen Boesch.

The Parelius residence, on a small promontory jutting into Lakewood Bay, was built almost ten years after Lakewood was platted by George F. Cottrell, a noted town-planning engineer. Marshall Brothers engineered each site in this district, west of State Street and bordering the Lake.

Elaborate advertisements and brochures were created by the Ladd Estate Company to sell off lots in the late twenties and early thirties. One such brochure described Lakewood as "Portland's only lake district. There are outdoor sports to be enjoyed in every season; fishing and boating most of the year; swimming during the summer; very good skating almost every winter Unusually attractive paths attract you to roam over Lakewood. Right now you will find wild flowers galore to lead you on and on through wooded and mossy glens, up over rocky upthrusts and tumbles of moss-grown boulders."

Previously thought to have been designed by prominent Oregon architect Wade Pipes, it is now believed that the house was designed by local architect Richard Sundeleaf. Sundeleaf was employed for a period of time as a draftsman for Pipes, who had traveled to England early in his professional career, and was inspired by the romantic beauty of English vernacular buildings. Often combining stucco with wood siding to cover his asymmetrical compositions, Sundeleaf and Pipes sought to achieve the rustic, romantic quality of medieval architecture. It is well preserved and well integrated into the prominent site at the juncture of Lakewood Bay and the main lake.

Bibliography:

Clackamas County Cultural Resource Inventory, Department of Transportation and Development, 1984.

Ticor Title Company Records, Oregon City, OR.

"Lakewood: Beside the Lake-beneath the trees" folder, Ladd Estate Company, circa 1927.

Parelius obituary, unknown publication, 11/18/82.