

**CITY OF LAKE OSWEGO
CULTURAL RESOURCES INVENTORY
FIELD FORM 1988-1989**

HIST. NAME: McCall, Mary, House
DATE OF CONSTRUCTION: 1930
COMMON NAME:
ORIGINAL USE: Residence
ADDRESS: 4144 South Shore Boulevard
OWNER: Doyle, Olivia Ruth
PRESENT USE: Residence
ARCH./BLDR.: John Graef, Builder
T/R/S: 2S 1E 8CC
TAX LOT: 8400

STYLE: English
Cottage
RESOURCE TYPE:
Building
THEME: Recreation
ADDITION: Lakeview
Villas #5
BLOCK:
LOT: 527
QUAD: Lake Oswego
LOT SIZE:
ZONE: R-7.5

PLAN TYPE/SHAPE: Asymmetrical
NO. OF STORIES: 1 1/2
FOUNDATION MATERIAL: Concrete
BASEMENT: Unknown
ROOF FORM & MATERIALS: Intersecting gable; wood shakes

WALL CONSTRUCTION~ Wood
STRUCTURAL FRAME: Stud
PRIMARY WINDOW TYPE: Multi-light casement and fixed sash
EXTERIOR SURFACING MATERIALS: Shingles
DECORATIVE FEATURES: polygonal window bay on facade

OTHER: Recessed entry; large exterior brick chimney
CONDITION: Good
EXTERIOR ALTERATIONS/ADDITIONS: None apparent
NOTEWORTHY LANDSCAPE FEATURES: Mature conifers in front yard
ASSOCIATED STRUCTURES: Carport

SETTING: Located on west side of South Shore Boulevard at west end of lake in residential *area* characterized by early to mid 20th century houses; one block south of Lakeview Boulevard and the Southern Pacific right-of-way
NOTES:

RECORDER(S): Koler/Morrison
SHPO #: 332

DATE: January 1989
FIELD #: 85

CITY OF LAKE OSWEGO CULTURAL RESOURCES INVENTORY

ADDRESS 4144 SOUTH SHORE BLVD
TAXMAP/LOT 2S 1E 8CC/8400
SHPO# _____ ROLL/FRAME# _____

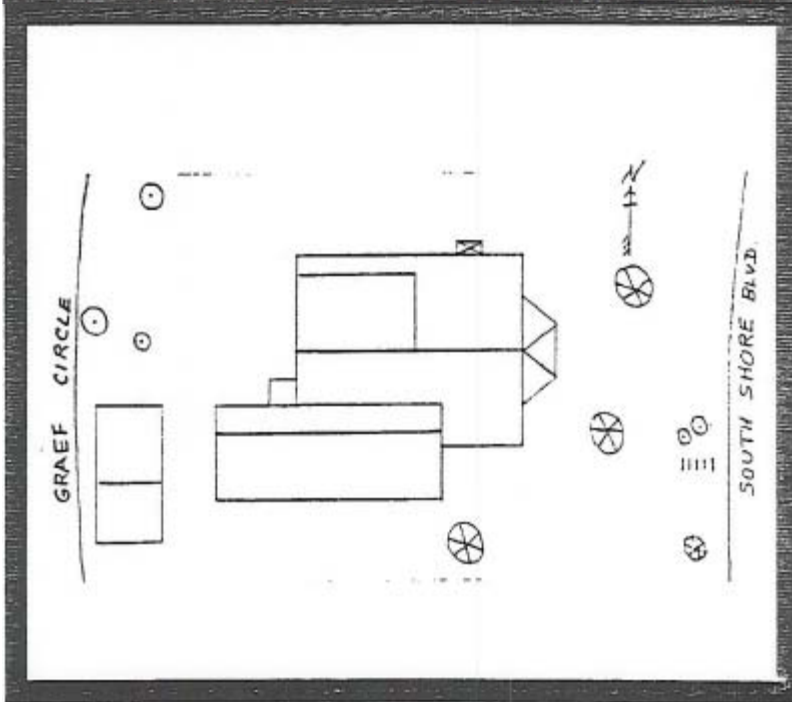

STATEMENT OF SIGNIFICANCE

Address: 4144 South Shore

Historic Name: McCall, Mary, House

This is one of several cottages built as summer retreats for Portland residents. The English Cottage style home sits on a small rise above the lake. According to title search records H. R. Macklay and his wife Lucy purchased the property in 1924 from Oregon Iron and Steel Company. They sold the property in 1928 to Mary McCall. McCall is believed to have had the cottage built shortly thereafter in 1930. She owned the house until 1940.

Located on the west end of the lake, South Shore was one of the first areas to open up for development in 1913 when Paul Murphy cleared sites around the lake to sell. Lakefront lots started at \$200. Summer cottages and homes were popular with Portlanders during that period. Oswego residents also began to build around the lake and lots sold quickly, even as prices rose, through the 1920s and 30s.

This house is relatively well-preserved and is important as one of few remaining cottages.

Bibliography:

Atchison-Allen Company post card advertisement, 1913.

Clackamas County Cultural Resource Inventory, Department of Transportation and Developmentr 1984.

"History of Lake Oswego" pamphlet, R. McAllister.

Ticor Title Company, Oregon City, OR.