

**CITY OF LAKE OSWEGO
CULTURAL RESOURCES INVENTORY
FIELD FORM 1988-1989**

HIST. NAME: Carter, Samuel Ho, House
DATE OF CONSTRUCTION: c. 1881
COMMON NAME:
ORIGINAL USE: Residence
ADDRESS: 17901 Stafford Road
OWNER: Patchett, Virginia
PRESENT USE: Residence
ARCH./BLDR.: Unknown
T/R/S: 2S 1E 16D
TAX LOT: 600

STYLE: Italianate
RESOURCE TYPE:
Building
THEME: Architecture
ADDITION: N/A
BLOCK:
LOT:
QUAD: Lake Oswego
LOT SIZE:
ZONE: R-15

PLAN TYPE/SHAPE: Rectangular
NO. OF STORIES: 2
FOUNDATION MATERIAL: Brick
BASEMENT: No
ROOF FORM & MATERIALS: Hip with deep eaves and decorative eave brackets;

WALL CONSTRUCTION: Wood
STRUCTURAL FR~E: Stud
PRIMARY WINDOW TYPE: Narrow double-hung sash with architrave molding -- some in pairs
EXTERIOR SURFACING MATERIALS: Shiplap with frieze and cornerboards
DECORATIVE FEATURES: Rectangular window bays; porch brackets; paneled door with transom

OTHER: Projecting one-story wing on west elevation; single-bay hipped porch on facade supported by chamfered posts; same type of porch repeated on side elevation

CONDITION: Good

EXTERIOR ALTERATIONS/ADDITIONS: Kitchen and pantry added, (n.d.)

NOTEWORTHY LANDSCAPE FEATURES: Massive deciduous trees, s. of house; ornamental plantings, especially along north side frontage

ASSOCIATED STRUCTURES: None

SETTING: Located on southwest corner of Stafford Road and Overlook Drive on southern edge of city limits; contemporary residential development encroaching from the north, east, and west; open farmland to east; golf course to north; World War II -era church to south

NOTES:

RECORDER(S): Koler/Morrison
SHPO #: 397c

DATE: January 1989
FIELD #: 223

CITY OF LAKE OSWEGO CULTURAL RESOURCES INVENTORY

ADDRESS 17901 STAFFORD ROAD
TAXMAP/LOT 2S 1E 16D/600
SHPO# _____ ROLL/FRAME# _____

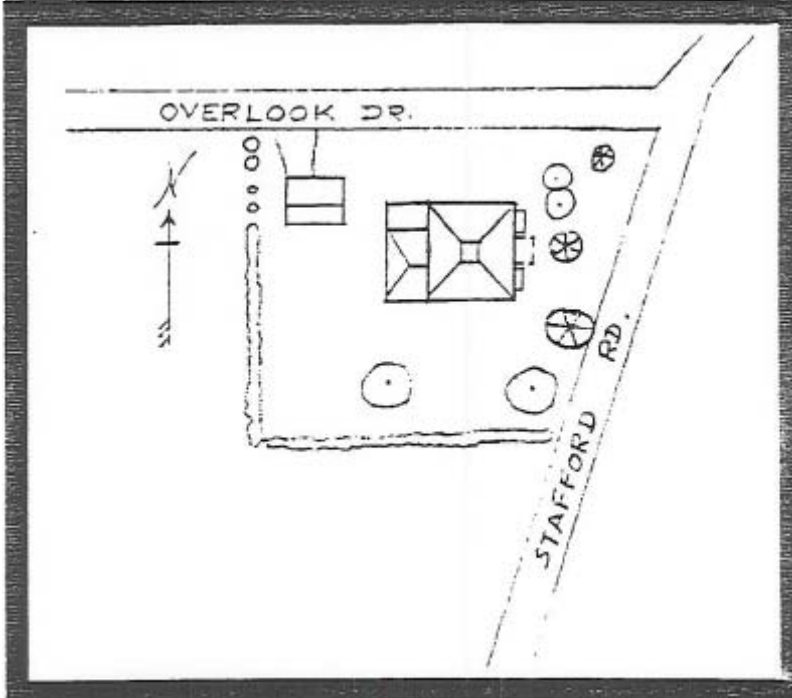

STATEMENT OF SIGNIFICANCE

Address: 17901 Stafford Road

Historic Name: Carter, .Samuel, House

Built circa 1881, the Carter house is the finest example of the Italianate style in the city and is therefore significant. The grounds are meticulously landscaped. The house is located in the Stafford area--tucked in between Lake Oswego, West Linn and Tualatin--which retains rural character.

Samuel H. and Lydia A. Carter purchased the property in 1881 from Adam R. and Celinda E. Shipley. Adam Shipley arrived in Oregon in the mid-1800s. He acquired a farm of approximately 1,000 acres in the Hazelia district extending to the Tualatin River and along its banks. Shipley, fondly called "Father Shipley" by locals in his day, shared his land with the first Oswego Grange which he was instrumental in organizing. A one room school was also built on his land in 1884.

Shipley was a prominent early citizen: he served as second Postmaster of Portland for several years; Clackamas County school superintendent; librarian at Oregon State College; Master of the State Grange; and, Sunday School leader at Oswego's first Methodist Church. In addition, Shipley helped to establish the Oswego cemetery in 1881 and was a charter member of the Odd Fellows Lodge.

Bibliography:

Clackamas County Cultural Resource Inventory, Department of Transportation and Development, 1984.

Ticor Title Company, Oregon City, OR.

Oregon's Iron Dream, Mary Goodall, 1958.