

**CITY OF LAKE OSWEGO
CULTURAL RESOURCES INVENTORY
FIELD FORM 1988-1989**

HIST. NAME: Rogers, George Bldg I

DATE OF CONSTRUCTION: 1925

COMMON NAME:

ORIGINAL USE: Store/Office

ADDRESS: 402 N. State Street

OWNER: VanBuren, Helene, 4273 SW Council
Crest Dr., Portland 97201

PRESENT USE: Store/Office

ARCH./BLDR.: Ertz, Charles

T/R/S: 2S 1E 3DD

TAX LOT: 5900

STYLE: Commercial

RESOURCE TYPE:

Building

THEME: Architecture,
Commerce

ADDITION: First

BLOCK: 49

LOT: 7,8

QUAD: Lake Oswego

LOT SIZE:

ZONE: EC

PLAN TYPE/SHAPE: Rectangular

NO. OF STORIES: 1

FOUNDATION MATERIAL: Concrete

BASEMENT: Yes

ROOF FORM & MATERIALS: Flat with corner turret; composition material

WALL CONSTRUCTION: Masonry

STRUCTURAL FRAME: Unknown

PRIMARY WINDOW TYPE: Display

EXTERIOR SURFACING MATERIALS: Stucco; ceramic tile bulkheads

DECORATIVE FEATURES: Bas-relief panel over corner entrance; pilaster caps

OTHER: Belt course at cornice line

CONDITION: Good

EXTERIOR ALTERATIONS/ADDITIONS: Some storefronts altered, (n.d.)

NOTEWORTHY LANDSCAPE FEATURES: None

ASSOCIATED STRUCTURES: None

SETTING: Prominently sited on northwest corner of "A" Street and State Street in heart of City's commercial core

NOTES:

RECORDER(S): Koler/Morrison

SHPO #: 309

DATE: January 1989

FIELD#: 35

CITY OF LAKE OSWEGO CULTURAL RESOURCES INVENTORY

ADDRESS 402 N. STATE STREET
TAX MAP/LOT 2S 1E 3DD/5900
SHPO# _____ ROLL/FRAME# _____

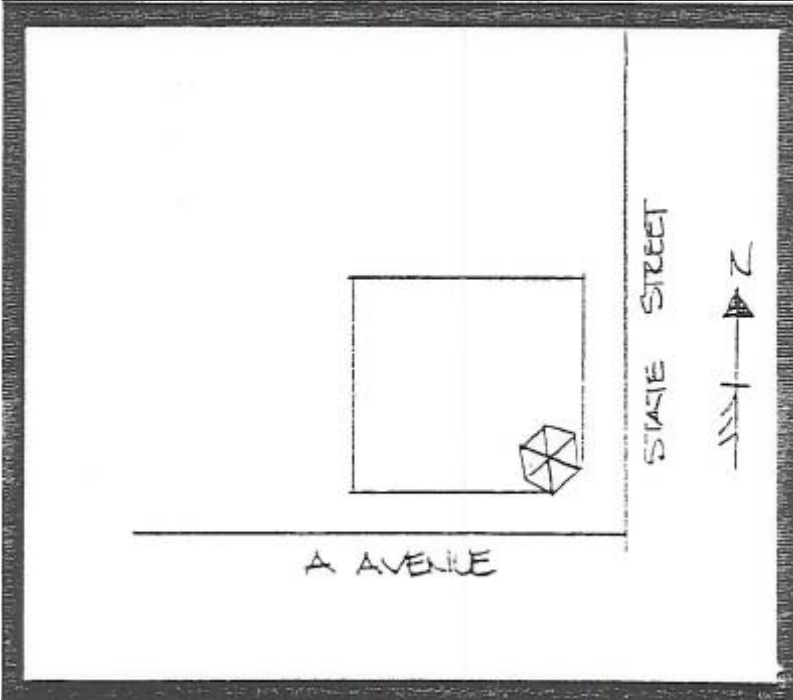

STATEMENT OF SIGNIFICANCE

Address: 402 North State Street
Historic Name: Rogers, George, Building

This Commercial style building was built in 1925 when George M. Rogers first acquired the property from the Improved Order of Redman Kesseah Tribe #39. According to oral history, Charles W. Ertz designed the building and "Tom Allen loaned money to George Rogers to buy that quarter block...to build some stores. Before that the Cochran's had a little lumber and hardware store in there, a two-story building and they lived above the store. He (Allen) turned it into a drugstore...".

Rogers (Rodrigues), a native of Portugal, transferred the property to a company which he and his brother had formed, called Lusitania Investment Company, in 1925. Lusitania leased the building to Thomas H. Allen who established the Oswego Pharmacy in 1930. The pharmacy, tucked in the corner of the building, had a lunch counter and soda fountain. Allen, in addition to running the drugstore, was a charter member of the American Legion post in Lake Oswego in 1933. The lease was renewed in 1949 under the name of Cook.

George Rogers was considered by many a leading citizen of Lake Oswego (see George Rogers House, 59 Wilbur Street). His grocery business lasted more than twenty years from the mid-twenties to the mid-forties. George and August Rogers first opened a grocery store on the corner of State Street and B Avenue in 1923. The business was successful, so two years later the brothers expanded into this location, which at the time was considered the "Washington Square" of Oswego. Situated in the northern portion of this State Street address, Roger's grocery store operated at the same time as Allen's pharmacy. Dr. Walter MacDougall, considered the "town doctor" in Oswego for many years, also occupied a suite of rooms adjacent to Allen's drugstore for two years during the late 1920s. Other businesses in the Rogers' spacious building included a bakery, barber shop, shoe store and warehouse. In 1927 the Rogers opened another store with a bakery and "cash and carry" grocery. (456 State Street).

Ertz's design reflects the popular commercial style of the day. The smooth stucco walls and cast ornamentation are typical features of a commercial building from the 1920s and 1930s. The prominent turreted corner entrance signifies the importance of the intersection and the pedestrian. The embellishment of the entrance shows inspiration from classical architecture. Griffins in bas-relief decorate a set of panels above the entrance. The panel design is repeated at the top of each pilaster. The main entrance doors have been replaced with mill-finish aluminum and the transoms over most of the display windows have been covered; ceramic tile has been applied to the pilasters and bulkheads. The transoms above the display windows at the north and west end of the major elevations retain their decorative mullions. These portions of the facade appear to be the best preserved elements of the building.

The Rogers' Building is significant as the best preserved example of early 20th century commercial architecture in the city as well as for its strong association with prominent citizen and businessman George Rogers. The building also contributes to the historic character of State Street.

Bibliography:

Baker, Lyle A., and Beckner, Mrs. William Mason, Recorded Interviews for "In Their Own Words" oral history project for L.O. Library, 1974.
Clackamas County Cultural Resource inventory. Department of Transportation and Development. 1984.
Oregon's Iron Dream. Mary Goodall, 1958.
"Oswego Structures Offer Peek at Past," by H. Schouten, Oregonian, 12/11/84.
Ticor Title Company, Oregon City, OR.