

**OREGON INVENTORY OF HISTORIC PROPERTIES
HISTORIC RESOURCE SURVEY FORM**

Note: For properties 35 years old and newer, starred (*) sections are the only required fields.

					*County: Clackamas	
*Street Address: 17600 Pacific Highway				*City Lake Oswego		
USGS Quad Name: Lake Oswego				GPS Reading, UTM Format (Universal Transverse Mercator): Longitude: 45.39887 -122.64728		
Township: 2S	Range: 1E	Section: 14	Block/Lot:	Tax Lot #: 400TI		
Historic Name: St. Catherine's Hall				Grouping or Cluster Name: Marylhurst University		
*Date of Construction: 1930		Other Name: St. Catherine's Dormitory				
Historic Use or Function: Education-Related		*Current Use: Education-Related		Associated Archaeological Site: Unknown		
Architectural Classification(s): Mediterranean		Plan Type/Shape: Simple/Rectangle		Number of stories: 3		
Foundation Material: Concrete		Structural Framing: Unknown		Moved? No		
Roof Type/Material: Side-Gabled/Red Clay Tile			Window Type/Material: Six-Over-Six and Six-Over-Nine Awning/ Wood			
Exterior Surface Materials Primary: Brick		Secondary: Concrete		Decorative: Brick Belt Courses and Metal Balconies with Balustrades		
Exterior Alterations or Additions, Approximate Date: Brick balustrade on the one-story bay was infilled, concrete ramp added, and landscape changes after 1989.						
Number and Type of Associated Resources: N/A						
Integrity: Excellent		Condition: Good		Local Eligibility: Eligible/Significant		National Register Listed? <input type="checkbox"/> Yes <input checked="" type="checkbox"/> No <input type="checkbox"/> Unknown
Preliminary National Register Findings:						
Potentially Eligible: <input checked="" type="checkbox"/> Individually or <input type="checkbox"/> As a contributing resource in a District						
Not Eligible: <input type="checkbox"/> Intact but lacks distinction or <input type="checkbox"/> Not 50 years old or <input type="checkbox"/> Altered - Choose one:						
<input type="checkbox"/> Reversible/ potentially eligible individually or in a District <input type="checkbox"/> Reversible/ ineligible, lacks distinction <input type="checkbox"/> Irretrievable lack of integrity						
*Researcher/ Organization: Kristen Minor & Brandon J. Grilc/Peter Meijer Architect, PC					Date Recorded: 02/08/2016	
					SHPO #: 31108	

**OREGON INVENTORY OF HISTORIC PROPERTIES
HISTORIC RESOURCE SURVEY FORM**

	*County: Clackamas
Street Address: 17600 Pacific Highway	City: Lake Oswego

Description of Physical and or Landscape Features:

St. Catherine's Hall is located north of Furman Drive North, southeast of Flavia Hall, and Northeast of the Marylhurst Administration Building on the 49-acre Marylhurst University campus in Lake Oswego, Oregon. The site, which slopes downward from west to east, is bounded by Furman Drive North and asphalt parking lots. Vegetation on the site includes large pine, cedar and holly trees to the south. Rhododendron, laurel, and other deciduous bushes and trees are located within a planter bed around the building. A concrete retaining wall lined with bushes is located to the south of the site. The site also includes a wood bench, historic marker, and concrete ramp with metal rail along the building's west façade.

St. Catherine's Hall faces west toward Flavia Hall. It is a three-story, rectangular form with a side-gable roof atop a concrete foundation with window openings where topography allows. A one-story round bay with brick balcony wall and gabled wall dormer are located on the west façade. The north, east, south, and west façades are faced with polychrome brick and concrete base, and feature six-over-six and six-over-nine awning wood windows with wood casing, masonry sills, and brick lintels. Six-light wood windows are located at the basement level on the north and east façades. Windows are used singly or paired. A rectangular wood vent is located under the flush gables with stepped-brick frieze and a brick soldier belt course runs along the façade below the third level. The main entrance is located on the west façade and consists of a single-door opening with a wood paneled door and flanking sidelights within a recessed vestibule. It is highlighted by an arched masonry opening with pine cone pendent at medallion key stone and is flanked by the one-story round bay. The bay features six-over-nine awning wood windows separated by cast stone pilasters, a stone trim band, and a brick balcony wall with stone cornice. The north and south façades feature secondary double-door openings with multi-light wood doors and metal balconies. The side-gabled roof is flush at gable walls and features a slight overhang on the west and east façades. It is finished with red clay tiles and copper gutters.

Since the last survey was recorded in 1989, the building's footprint has not changed. However, the one-story bay's brick balustrade was infilled, the concrete ramp with metal railing was installed on the west façade, and changes were made to the landscape. Landscape changes include the installation of the historic marker and bench near the main entrance, and the removal of signage along Furman Drive North. The date of these alterations and additions are unknown. Based on historic photos, St. Catherine's Hall once included tall bushes along its west façade, a stone bench near the main entrance, and an open grass quad to the west.

St. Catherine's Hall has many of the features used to define Mediterranean style buildings that were common during its time of construction. These features include red tile roof covering, buff colored polychrome brick cladding, arched openings, asymmetrical façades, ornate door surrounds, open balconies, and uninterrupted gable walls with little to no overhang.

*Researcher/ Organization: Kristen Minor & Brandon J. Grilc/Peter Meijer Architect, PC	Date Recorded: 02/08/2016
	SHPO #: 31108

**OREGON INVENTORY OF HISTORIC PROPERTIES
HISTORIC RESOURCE SURVEY FORM**

	*County: Clackamas
Street Address: 17600 Pacific Highway	City: Lake Oswego

Statement of Significance: [Required only for Intensive Level Surveys] (Use additional sheets if necessary)

St. Catherine's Hall is located at 17600 Pacific Highway in Lake Oswego, Oregon. Built in 1930 from a design by Jacobberger & Smith as part of the Marylhurst University, this building has retained excellent historic integrity and has become a prime local example of Mediterranean style buildings common throughout the United States from 1890-1955.

St. Catherine's Hall sits on land originally owned by Jesse and Nancy Bullock as part of their Donation Land Claim. "The land which later became the site of Marylhurst College was the Bullock Claim, settled by Jesse Bullock and his wife, Nancy Howard, February 26, 1850. They were a southern couple. Jesse was born in North Carolina in 1808 and his wife in Nashville, Tennessee, in 1817" (Goodall 27). The Bullocks crossed the plains in 1848 along the Oregon Trail, where they lost two of their children. They first arrived in Oregon City where they settled, as Jesse headed "south to the gold rush" (Goodall 28). Once he returned, "he moved his family to a 618-acre tract on the river bank near Oswego" (Goodall 28). Jesse died in 1886 and his Nancy died in 1872 (Goodall 28).

In 1859, "a group of friends and relatives of twelve nuns," set sail from Montreal, Canada to Portland, Oregon. "The Sisters had come prepared to educate children, but from the moment the doors of their first school opened, they were called upon to care for orphans, the poor, the sick and the despairing" (Goodall 103). In 1893, the Sisters of the Holy Names of Jesus and Mary founded the St. Mary's Academy downtown, Portland (Marylhurst). In 1898, "the Sisters petitioned the State Legislature for a revision of their charter for the purpose of offering college course leading to bachelor's degrees. This was granted and St. Mary's Academy had 'and college' added to its name" (Goodall 104). By 1906, the Sisters, who were based in Portland, purchased land in Oak Grove, Oregon and in Marylhurst with the intent of having an orphanage and college constructed (St. Mary's Academy). Archbishop Alexander A. Christie who had land adjoining the Sisters' tract in Marylhurst realized their need "and exchanged this land for the Oak Grove property, thus making the sizable piece that was needed" (Goodall 103). In 1907, the Christie School was built on the newly acquired site. Originally, this site was called "Villa Marie" but it was later changed by Christie to Marylhurst in 1913 (Foster 74). In 1912, "the Sisters opened the Holy Names Normal School" (Foster 74), which acted as a sister school to St. Mary's College in Portland. "In 1919 the normal school became the Marylhurst Normal School" (Foster 74). After the St. Mary's College moved to Marylhurst in 1930, it became Marylhurst College. Marylhurst was reported to be the only Catholic college for women in the northwest, and the Sisters of the Holy Names organized a campaign to raise funds for the college in 1930 ("Marylhurst Plans New College Home," The Sunday Oregonian). Twenty years later in 1950, the two schools joined (Foster 74).

In 1974, Marylhurst became a "co-educational institution and the first liberal arts college in the county designated as a college for lifelong learning" and in 1998 Marylhurst College became Marylhurst University (Marylhurst).

St. Catherine's Hall was one of three Marylhurst buildings initially built at the same time on the 237-acre Catholic girls' school campus. The three buildings (including also the chaplain's residence, now Aquinas Hall; and the "main building," now BP John Administration Building) were initially reported to cost \$260,000. The "residential hall will be 85 x 40 in dimensions, and will be of concrete, steel and brick, wholly fireproof" ("Work on School Begins," Oregonian). The contractor for the work on all three buildings was Tranchell & Parelius. The building program cost was later revised upwards to \$300,000 ("Marylhurst Plans New College Home" The Sunday Oregonian). According the last survey conducted on this property in 1989, St. Catherine's Hall was originally named St. Rose Hall and has since been repurposed as the Music Department. It was reported in 1937 with the construction of the new Flavia Hall dormitory that St. Rose Hall would serve as "quarters for home economics students" ("New Dormitory At Marylhurst Nearly Ready," Oregonian).

Today, the building continues to reflect many of the character-defining features associated with Mediterranean style buildings common during its time of construction. These features include red tile roof covering, buff colored polychrome brick cladding, arched openings, asymmetrical façades, ornate door surrounds, opening balconies, and uninterrupted gable walls with little to no overhang. St. Catherine's Hall was designed by Jacobberger & Smith.

Joseph Jacobberger was born in Alsace-Lorraine, France in 1867. At the age of two, Jacobberger immigrated to the United States with his family of eight, where he was raised in Omaha, Nebraska (Michelson). As a young adult, Jacobberger attended Creighton University. After attending university, Jacobberger took his first position in Minneapolis, Minnesota. In 1890, he moved to Portland, Oregon where he worked at the office of Whidden & Lewis. By 1900, Jacobberger started his own firm in Portland where he later formed a partnership with Alfred H. Smith. This partnership lasted until his death on March 18, 1930, at which point it was continued by his son Francis B. Jacobberger remaining as Jacobberger & Smith (Ritz 206-207). Notable works of Joseph Jacobberger include his country house in 1917, the Auto Rest Garage in 1917, St Mary's Cathedral in 1925, the Church of the Madeleine, the Gradeners and Ranchers Market, and the addition to the St. Vincent Hospital in 1930 (Ritz 207).

Alfred Henry Smith was said to be born about 1865 in Bristol, England. By 1908, Smith moved to Portland, Oregon where he started his own architecture firm in 1911. One year later, Smith began his partnership with Joseph Jacobberger, who at the time had been working in Portland for twelve years. Smith and Jacobberger worked together until Jacobberger's death in 1930, at which point Francis B. Jacobberger took over for his father Joseph. After Smith left the firm in 1930, he taught drafting at Benson High School in Portland. On May 9, 1958, Alfred Henry Smith died in Portland, at the age of 93 (Ritz 359).

Noted works of Jacobberger and Smith include the Portland Hunt Club in 1916, the Holy Child Academy Convent in 1917, St. Phillips Neri Rectory and Assembly Hall in 1918, St. Mary's Home for Boys at Beaverton in 1918, the Knights of Columbus Building in 1920, the Gardeners and Ranchers Building in 1920, and multiple residences throughout Portland and Lake Oswego.

Currently, St. Catherine's Hall retains excellent historic integrity. It continues to embody many of the Mediterranean style characteristics used during its time of construction, making it a prime example of its style and type.

Overall, based on the information gathered for this survey and further research, it is more than likely that the St. Catherine's Hall can be found significant in the areas of architecture and education. Given its retention of all aspects of integrity of historic integrity, and its contributions to the educational development of Marylhurst University, St. Catherine's Hall is also potentially eligible for National Register listing individually or as a contributing resource in a potential historic district.

*Researcher/ Organization: Kristen Minor & Brandon J. Grilc/Peter Meijer Architect, PC	Date Recorded: 02/08/2016
---	------------------------------

SHPO #: 31108

**OREGON INVENTORY OF HISTORIC PROPERTIES
HISTORIC RESOURCE SURVEY FORM**

	*County: Clackamas
Street Address: 17600 Pacific Highway	City: Lake Oswego



West Façade (Viewing Northeast)



East Façade (Viewing Northwest)

*Researcher/ Organization: Kristen Minor & Brandon J. Grilc/Peter Meijer Architect, PC		Date Recorded: 02/08/2016	
*Photo Roll #:	*Frame #(s):	Local Designation #:	SHPO #: 31108

OREGON INVENTORY OF HISTORIC PROPERTIES
HISTORIC RESOURCE SURVEY FORM

	*County: Clackamas
Street Address: 17600 Pacific Highway	City: Lake Oswego

St.Catherine's Hall Site Plan

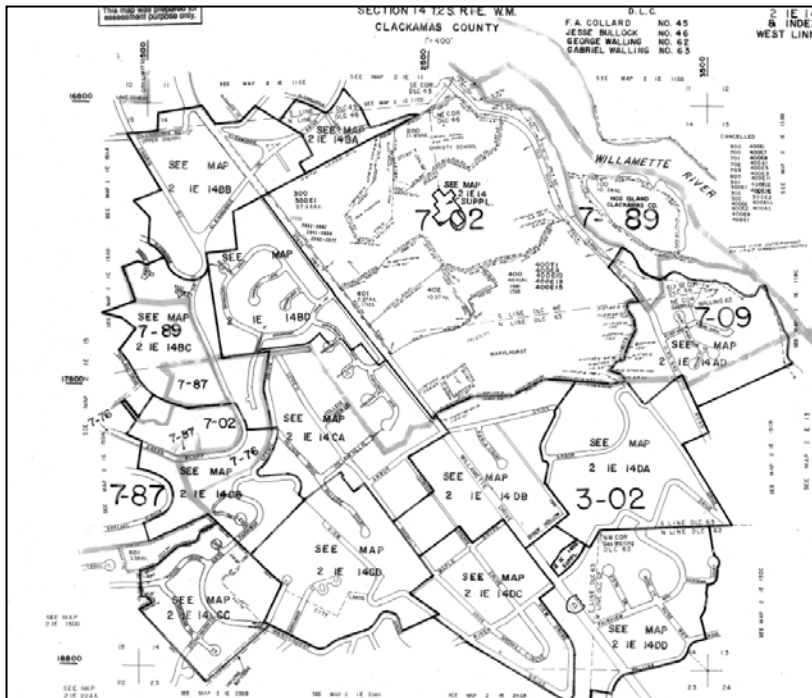
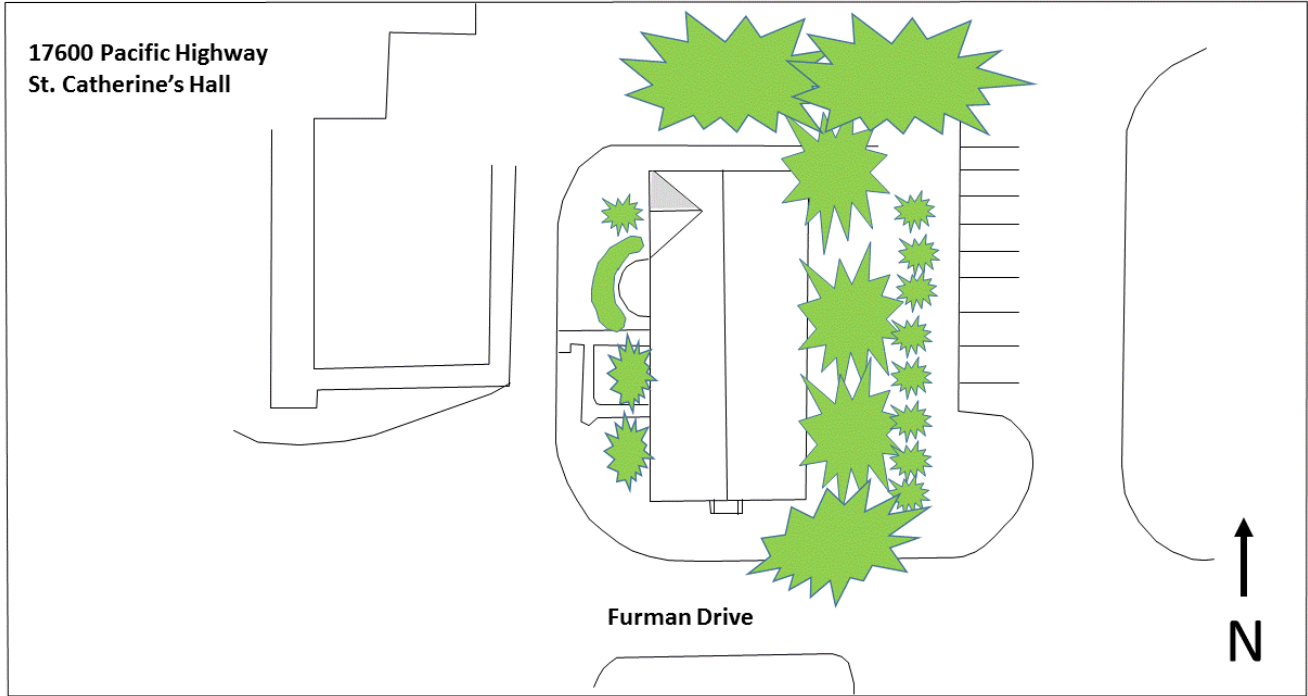

*Researcher/ Organization: Kristen Minor & Brandon J. Grilc/Peter Meijer Architect, PC		Date Recorded: 02/08/2016	
*Photo Roll #:	*Frame #(s):	Local Designation #:	SHPO #: 31108

**OREGON INVENTORY OF HISTORIC PROPERTIES
HISTORIC RESOURCE SURVEY FORM**

Note: This page of the survey form is required only for Intensive Level Survey

		*County: Clackamas
Street Address: 17600 Pacific Highway		City: Lake Oswego
Architect and / or Builder(s): Jacobberger & Smith / Tranchell & Parelus	Owner Type: <input checked="" type="checkbox"/> Private <input type="checkbox"/> Local <input type="checkbox"/> State <input type="checkbox"/> Federal <input type="checkbox"/> Mixed	
Addition or Subdivision Name: Marylhurst	Owner Name(s):	
Area(s) of Significance: Architecture and Education	Address:	
Property Category: <input checked="" type="checkbox"/> Building <input type="checkbox"/> Structure <input type="checkbox"/> Site <input type="checkbox"/> Object <input type="checkbox"/> District	City, State, Zip:	
Phone Number(s):		
Documentation		
Research Sources: <input type="checkbox"/> Title/ Deed Records <input type="checkbox"/> Sanborn Maps <input type="checkbox"/> Obituary Index <input type="checkbox"/> City Directories <input type="checkbox"/> Census Records <input type="checkbox"/> Biographical Encyclopedias <input checked="" type="checkbox"/> Newspapers	<input type="checkbox"/> Building Permits <input checked="" type="checkbox"/> Tax Records <input checked="" type="checkbox"/> SHPO Files <input type="checkbox"/> State Archives <input type="checkbox"/> State Library <input type="checkbox"/> Local Histories <input type="checkbox"/> Personal Interviews <input checked="" type="checkbox"/> Historic Photographs	Local Library (specify): Lake Oswego Public Library Multnomah County Library University Library (specify): Historical Society (specify): Holy Names Heritage Center Other (specify):
*Researcher/ Organization: Kristen Minor & Brandon J. Grilc/Peter Meijer Architect, PC		Date Recorded: 02/08/2016
		SHPO #: 31108

**OREGON INVENTORY OF HISTORIC PROPERTIES
HISTORIC RESOURCE SURVEY FORM**

	*County: Clackamas
Street Address: 17600 Pacific Highway	City: Lake Oswego

Bibliographic References (Books, articles, interviews, etc.)

Foster, Laura O. *Images of America: Lake Oswego*. Charleston: Arcadia Publishing, 2009.

Goodall, Mary. *Oregon's Iron Dream: A Story of Old Oswego and the proposed Iron Empire of the West*. Portland: Binfords & Mort, 1958.

Jacobberger, Joseph. *Joseph and Francis Jacobberger architectural papers [manuscript]*. c1895-1964.

"Marylhurst Plans New College Home." *The Sunday Oregonian*. April 27, 1930.

Marylhurst University. "History of Marylhurst University." <http://www.marylhurst.edu/about-marylhurst/history/>.

"New Dormitory At Marylhurst Nearly Ready." *The Oregonian*. August 15, 1937.

Ritz, Richard. *Architects of Oregon: A Biographical Dictionary of Architects Deceased – 19th and 20th Centuries*. Portland: Lair Hill. 2003.

St. Mary's Academy. *Timeline*. http://www.stmaryspdx.org/about/our_history/timeline/.

"Work on School Begins." *The Oregonian*. November 17, 1929.

*Researcher/ Organization:
Kristen Minor & Brandon J. Grilc/Peter Meijer Architect, PC

Date Recorded:
02/08/2016

SHPO #:
31108