

**OREGON INVENTORY OF HISTORIC PROPERTIES
HISTORIC RESOURCE SURVEY FORM**

Note: For properties 35 years old and newer, starred (*) sections are the only required fields.

					*County: Clackamas	
*Street Address: 17600 Pacific Highway				*City Lake Oswego		
USGS Quad Name: Lake Oswego				GPS Reading, UTM Format (Universal Transverse Mercator): Longitude: 45.39900 -122.64801		
Township: 2S	Range: 1E	Section: 14	Block/Lot:	Tax Lot #: 400TI		
Historic Name: Flavia Hall				Grouping or Cluster Name: Marylhurst University		
*Date of Construction: 1937		Other Name:				
Historic Use or Function: EDUCATION: Dormitory		*Current Use: Education: general		Associated Archaeological Site: Unknown		
Architectural Classification(s): Mediterranean		Plan Type/Shape: Compound/L-Shape		Number of stories: 2		
Foundation Material: Concrete		Structural Framing: Unknown		Moved? No		
Roof Type/Material: Hipped/Red Clay Tile; Flat			Window Type/Material: Multi-Light Casement/Wood; Multi-Light Awning/Wood; Multi-Light Casement with Fanlight Transom/Wood			
Exterior Surface Materials Primary: Brick		Secondary: Concrete		Decorative: Brick Belt Courses		
Exterior Alterations or Additions, Approximate Date: One-story brick wings along the north façade of the second unit were added after 1989.						
Number and Type of Associated Resources: N/A						
Integrity: Excellent		Condition: Good		Local Eligibility: Eligible/Contributing		National Register Listed? <input type="checkbox"/> Yes <input checked="" type="checkbox"/> No <input type="checkbox"/> Unknown
Preliminary National Register Findings:						
Potentially Eligible: <input type="checkbox"/> Individually or <input checked="" type="checkbox"/> As a contributing resource in a District						
Not Eligible: <input type="checkbox"/> Intact but lacks distinction or <input type="checkbox"/> Not 50 years old or <input type="checkbox"/> Altered - Choose one:						
<input type="checkbox"/> Reversible/ potentially eligible individually or in a District <input type="checkbox"/> Reversible/ ineligible, lacks distinction <input type="checkbox"/> Irretrievable lack of integrity						
*Researcher/ Organization: Kristen Minor & Brandon J. Grilc/Peter Meijer Architect, PC					Date Recorded: 02/08/2016	
					SHPO #: 31109	

**OREGON INVENTORY OF HISTORIC PROPERTIES
HISTORIC RESOURCE SURVEY FORM**

	*County: Clackamas
Street Address: 17600 Pacific Highway	City: Lake Oswego

Description of Physical and or Landscape Features:

Flavia Hall is located north of the Marylhurst Administration Building and between Aquinas Hall to the west and St. Catherine's Dormitory to the east on the 49-acre Marylhurst University campus in Lake Oswego, Oregon. The site, which slopes downward from west to east, is bounded by a small nine-space asphalt parking lot to the south on Furman Drive North, an asphalt road to the east, and a dense wooded ravine to the northwest. A two-story brick heating plant with smoke stack is located to the north of the property. Vegetation includes deciduous and pine trees throughout and bushes, hedges, and shrubs in a planter bed around the building. The site also includes a concrete sidewalk along its west, east, and south boundary, wood benches, metal bollard light fixtures along walkways, and historically inspired metal lamp posts along Furman Drive North.

Flavia Hall faces south toward Furman Drive North. It is a two-story, irregularly-shaped form. The building consists of two units: the primary two-story, side-gabled, rectangular unit with three east-facing projecting hipped wall dormers and a two-story, square-shaped unit with flat roof and parapet. A protruding square tower with hipped pyramidal roof is located on the east façade where the two units join. The north, east, south, and west façades are faced with polychrome brick and concrete base with a corbeled brick soldier belt course cap and feature recessed eight-light wood casement windows with wood casing. The second unit features four-light and eight-light wood casement windows, and ten-light wood casement windows with fanlight wood transoms. Windows are used singly or paired. The primary unit features a three running bond brick belt courses with two recessed brick courses between the first- and second-level windows and chamfered wall corners with reeding detail. The second unit includes a second corbeled brick soldier belt course above its second-level windows and a brick staircase on its east façade. The main entrance is located on the south façade and consists of a recessed double-door opening with multi-light single-panel wood doors with matching sidelights and leaded transom. A multi-light window with wood base is located directly above the entrance transom. The primary entrance is highlighted by concrete steps with metal railing and a concrete path embossed with an "M" and lined with magnolia trees. The roof on the west unit features a slight overhang and is finished with red clay tiles and copper gutters. The roof on the east unit consists of flat roof with capped parapet and corbeled brick cornice. A corbel-capped brick chimney is located on the north façade of the east unit.

A detached one-story, square-shaped heating plant is located to the north of the building. It is faced with polychrome brick and features four-light wood casement windows. A single-door opening with flush-panel wood door is located on the south façade. The roof is flat with parapet and features a brick soldier cornice. A stacked brick smokestack protrudes from the building.

Since the last survey was recorded in 1989, the building's footprint has not changed. However, landscaping changes have been made. These changes include the planting or growth of magnolia trees along the primary concrete path, the extension of the front lawn towards Furman Drive North, and the addition of benches and bollard light fixtures. The date of these alterations and additions are unknown. Based on historic photos, the landscape at one time also included tall bushes and Italian cypress trees surrounding the building. It is also likely that two, one-story brick wings along the north façade of the second unit were added after 1989. The date of this alteration is unknown.

Flavia Hall has many of the features used to define Mediterranean style buildings that were common during its time of construction. These features include red tile roof covering, buff colored polychrome brick cladding, gable walls with little to no overhang, arched windows, projecting wings, and asymmetrical design.

*Researcher/ Organization: Kristen Minor & Brandon J. Grilc/Peter Meijer Architect, PC	Date Recorded: 02/08/2016
	SHPO #: 31109

**OREGON INVENTORY OF HISTORIC PROPERTIES
HISTORIC RESOURCE SURVEY FORM**

	*County: Clackamas
Street Address: 17600 Pacific Highway	City: Lake Oswego

Statement of Significance: [Required only for Intensive Level Surveys] (Use additional sheets if necessary)

Flavia Hall is located at 17600 Pacific Highway in Lake Oswego, Oregon. Built in 1937 and designed by Francis B. Jacobberger as part of the Marylhurst University, this building has retained excellent historic integrity and has become a prime local example of Mediterranean style common throughout the United States from 1890-1955.

Flavia Hall sits on land originally owned by Jesse and Nancy Bullock as part of their Donation Land Claim. "The land which later became the site of Marylhurst College was the Bullock Claim, settled by Jesse Bullock and his wife, Nancy Howard, February 26, 1850. They were a southern couple. Jesse was born in North Carolina in 1808 and his wife in Nashville, Tennessee, in 1817" (Goodall 27). The Bullocks crossed the plains in 1848 along the Oregon Trail, where they lost two of their children. They first arrived in Oregon City where they settled, as Jesse headed "south to the gold rush" (Goodall 28). Once he returned, "he moved his family to a 618-acre tract on the river bank near Oswego" (Goodall 28). Jesse died in 1886 and his wife Nancy died in 1872 (Goodall 28).

In 1859, "a group of friends and relatives of twelve nuns," set sail from Montreal, Canada to Portland, Oregon. "The Sisters had come prepared to educate children, but from the moment the doors of their first school opened, they were called upon to care for orphans, the poor, the sick and the despairing" (Goodall 103). In 1893, the Sisters of the Holy Names of Jesus and Mary founded the St. Mary's Academy downtown, Portland (Marylhurst). In 1898, "the Sisters petitioned the State Legislature for a revision of their charter for the purpose of offering college course leading to bachelor's degrees. This was granted and St. Mary's Academy had 'and college' added to its name" (Goodall 104). By 1906, the Sisters, who were based in Portland, purchased land in Oak Grove, Oregon and in Marylhurst with the intent of having an orphanage and college constructed (St. Mary's Academy). Archbishop Alexander A. Christie who had land adjoining the Sisters' tract in Marylhurst realized their need "and exchanged this land for the Oak Grove property, thus making the sizable piece that was needed" (Goodall 103). In 1907, the Christie School was built on site. Originally, this site was called "Villa Marie" but it was later changed by Christie to Marylhurst in 1913 (Foster 74). In 1912, "the Sisters opened the Holy Names Normal School" (Foster 74), which acted as a sister school to St. Mary's College in Portland. "In 1919 the normal school became the Marylhurst Normal School" (Foster 74). After the St. Mary's College moved to Marylhurst in 1930, it became Marylhurst College. Marylhurst was reported to be the only Catholic college for women in the northwest, and the Sisters of the Holy Names organized a campaign to raise funds for the college in 1930 ("Marylhurst Plans New College Home," The Sunday Oregonian). Twenty years later in 1950, the two schools joined (Foster 74).

In 1974, Marylhurst became a "co-educational institution and the first liberal arts college in the county designated as a college for lifelong learning" and in 1998 Marylhurst College became Marylhurst University (Marylhurst).

Flavia Hall was designed to be a "perpetual tribute to the accomplishments of Mother Mary Flavia, beloved member of the Order of the Holy Names of Jesus and Mary" ("School Alumnae To Start Trust Fund for Mother" The Sunday Oregonian). Mother Mary Flavia was in the order for 60 years and was "instrumental in the foundation of Marylhurst Normal school, Marylhurst college and Holy Names Normal in her various positions as provincial superior and superior of Holy Names Normal, St. Mary's academy and Holy Redeemer School" ("School Alumnae To Start Trust Fund for Mother" The Sunday Oregonian). According the last survey conducted on this property in 1989, Flavia Hall was used as a dormitory and then later used for offices.

Today, the building continues to reflect many of the character-defining features associated with Mediterranean style buildings common during its time of construction. These features include red tile roof covering, buff colored polychrome brick cladding, gable walls with little to no overhang, arched windows, projecting bays, and asymmetrical design. The design of Flavia Hall is the work of Francis B. Jacobberger.

Born in Los Angeles in 1898 to Joseph and Anna Jacobberger, Francis B. Jacobberger soon found himself in Portland, Oregon where his family first settled in 1890. Joseph Jacobberger was a prominent Portland architect who was known for his church designs and the original three Marylhurst College buildings. Francis Jacobberger attended Columbia Prep School in Portland and went on to graduate from the University of Oregon School Of Architecture. After graduating, Jacobberger worked for his father until his death in 1930, at which point he continued the firm under his name for 15 years (Ritz 205). In 1945, Jacobberger partnered with Elmer Gottlieb Zeller creating Jacobberger & Zeller. Years later, Jacobberger began a cycle of adding and dropping partners from his firm, such as John Joseph Stanton from 1946 to 1960, Elmer Zeller from 1945 to 1948, and Everett B. Franks and Richard W. Norman in 1956. Francis B. Jacobberger died in Portland on February 4, 1962 (Ritz 205). Notable works by Jacobberger and his firm include churches, the Providence Hospital, Central Catholic High School, Portland University Engineering Building, and Mt. St. Josephs Home for the Aged (Ritz 206). Others works include the Holy Trinity Greek Orthodox Cathedral, the Harrison Park School in 1949, the Lent School in 1949, and multiple buildings on the Oregon State School for the Blind campus in 1957 and 1958 (University of Oregon).

Currently, Flavia Hall retains excellent historic integrity. It continues to embody many of the Mediterranean style characteristics used during its time of construction, making it a prime example of its style and type.

Overall, based on the information gathered for this survey and further research, it is more than likely that Flavia Hall can be found significant in the areas of architecture and education. Given its retention of all aspects of integrity of historic integrity, and its contributions to the educational development of Marylhurst University, Flavia Hall could also be a contributing resource in a potential historic district.

*Researcher/ Organization: Kristen Minor & Brandon J. Grilc/Peter Meijer Architect, PC	Date Recorded: 02/08/2016
SHPO #: 31109	

**OREGON INVENTORY OF HISTORIC PROPERTIES
HISTORIC RESOURCE SURVEY FORM**

	*County: Clackamas
Street Address: 17600 Pacific Highway	City: Lake Oswego



South Façade (Viewing Northeast)



North Façade (Viewing Southwest)

*Researcher/ Organization: Kristen Minor & Brandon J. Grilc/Peter Meijer Architect, PC		Date Recorded: 02/08/2016	
*Photo Roll #:	*Frame #(s):	Local Designation #:	SHPO #: 31109

**OREGON INVENTORY OF HISTORIC PROPERTIES
HISTORIC RESOURCE SURVEY FORM**

*County:
Clackamas

Street Address:
17600 Pacific Highway

City:
Lake Oswego

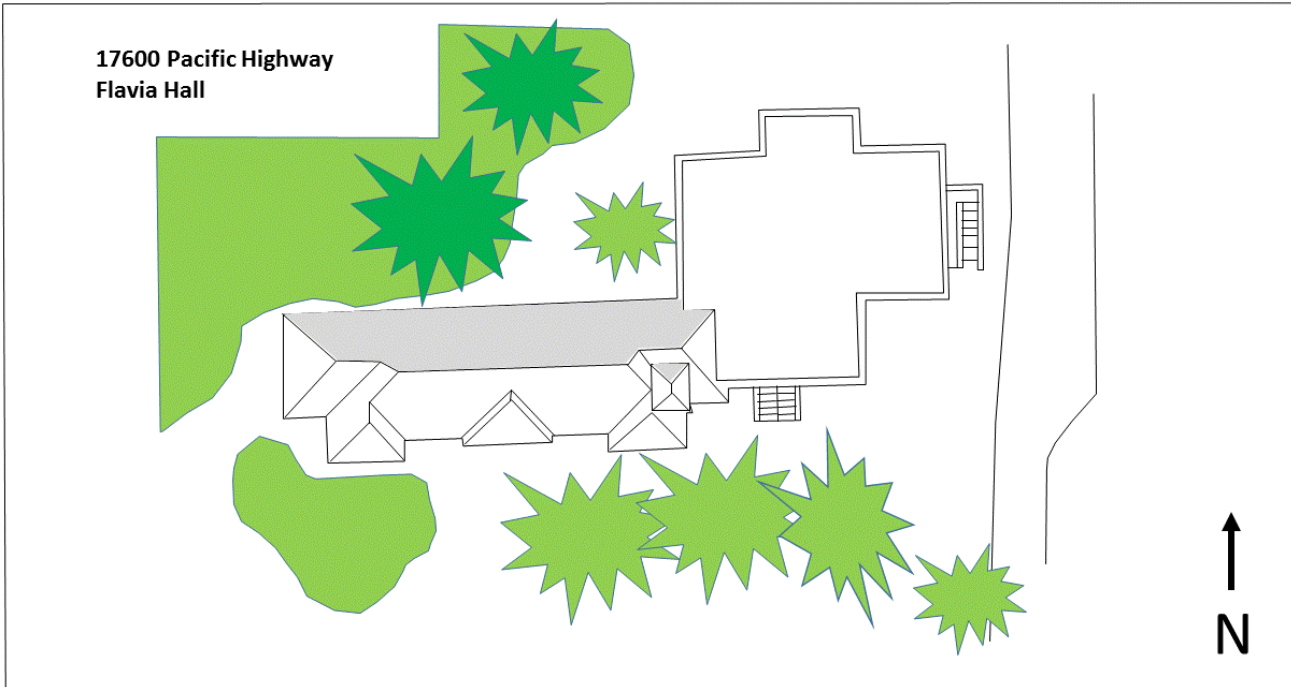

Flavia Hall Site Plan

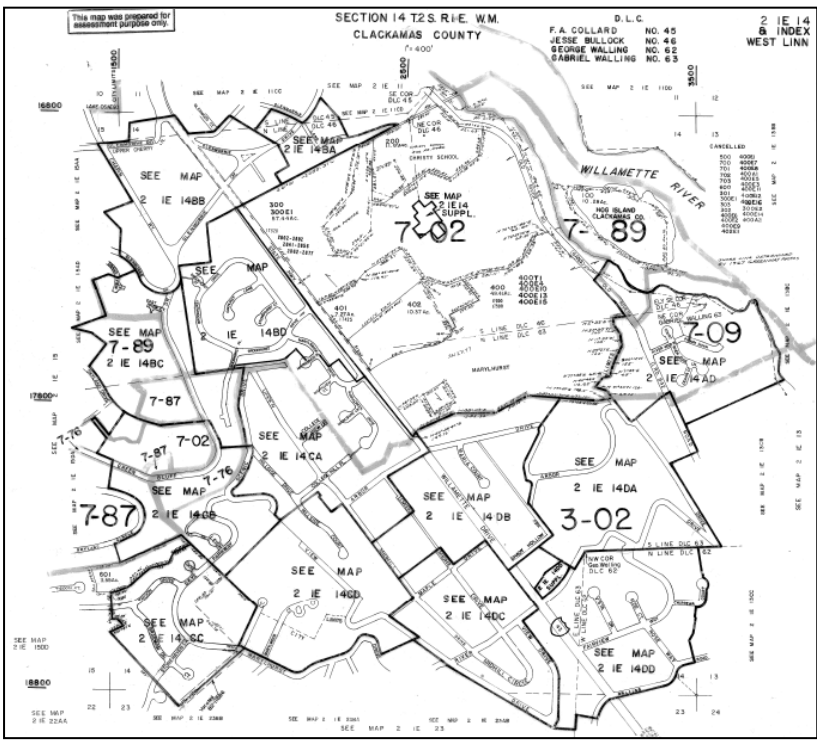

*Researcher/ Organization:
Kristen Minor & Brandon J. Grilc/Peter Meijer Architect, PC

Date Recorded:
02/08/2016

*Photo Roll #:

*Frame #(s):

Local Designation #:

SHPO #:
31109

**OREGON INVENTORY OF HISTORIC PROPERTIES
HISTORIC RESOURCE SURVEY FORM**

Note: This page of the survey form is required only for Intensive Level Survey

		*County: Clackamas
Street Address: 17600 Pacific Highway		City: Lake Oswego
Architect and / or Builder(s): Francis B. Jacobberger	Owner Type: <input checked="" type="checkbox"/> Private <input type="checkbox"/> Local <input type="checkbox"/> State <input type="checkbox"/> Federal <input type="checkbox"/> Mixed	
Addition or Subdivision Name: Marylhurst	Owner Name(s):	
Area(s) of Significance: Architecture and Education	Address:	
Property Category: <input checked="" type="checkbox"/> Building <input type="checkbox"/> Structure <input type="checkbox"/> Site <input type="checkbox"/> Object <input type="checkbox"/> District	City, State, Zip:	
Phone Number(s):		
Documentation		
Research Sources: <input type="checkbox"/> Title/ Deed Records <input type="checkbox"/> Sanborn Maps <input type="checkbox"/> Obituary Index <input type="checkbox"/> City Directories <input type="checkbox"/> Census Records <input type="checkbox"/> Biographical Encyclopedias <input checked="" type="checkbox"/> Newspapers	<input type="checkbox"/> Building Permits <input checked="" type="checkbox"/> Tax Records <input checked="" type="checkbox"/> SHPO Files <input type="checkbox"/> State Archives <input type="checkbox"/> State Library <input type="checkbox"/> Local Histories <input type="checkbox"/> Personal Interviews <input checked="" type="checkbox"/> Historic Photographs	Local Library (specify): Lake Oswego Public Library Multnomah County Library University Library (specify): Historical Society (specify): Holy Names Heritage Center Other (specify):
*Researcher/ Organization: Kristen Minor & Brandon J. Grilc/Peter Meijer Architect, PC		Date Recorded: 02/08/2016
		SHPO #: 31109

**OREGON INVENTORY OF HISTORIC PROPERTIES
HISTORIC RESOURCE SURVEY FORM**

	*County: Clackamas
Street Address: 17600 Pacific Highway	City: Lake Oswego

Bibliographic References (Books, articles, interviews, etc.)

Foster, Laura O. *Images of America: Lake Oswego*. Charleston: Arcadia Publishing, 2009.

Goodall, Mary. *Oregon's Iron Dream: A Story of Old Oswego and the proposed Iron Empire of the West*. Portland: Binford & Mort, 1958.

Jacobberger, Joseph. *Joseph and Francis Jacobberger architectural papers [manuscript]*. c1895-1964.

"Marylhurst Plans New College Home." *The Sunday Oregonian*. April 27, 1930.

Marylhurst University. "History of Marylhurst University." <http://www.marylhurst.edu/about-marylhurst/history/>.

Ritz, Richard. *Architects of Oregon: A Biographical Dictionary of Architects Deceased – 19th and 20th Centuries*. Portland: Lair Hill, 2003.

"School Alumnae To Start Trust Fund for Mother." *The Sunday Oregonian*. May 23, 1937.

St. Mary's Academy. *Timeline*. http://www.stmaryspdx.org/about/our_history/timeline/.

University of Oregon Library Digital Collections. *Francis B. Jacobberger (architect, 1898-1962)*.
[http://oregondigital.org/cdm4/results.php?CISOOP1=exact&CISOFIELD1=CISOSEARCHALL&CISOROOT=/archpnw&CISOBX1=Francis+B.+Jacobberger+\(architect%2C+1898-1962\)&CISOSTART=1,21](http://oregondigital.org/cdm4/results.php?CISOOP1=exact&CISOFIELD1=CISOSEARCHALL&CISOROOT=/archpnw&CISOBX1=Francis+B.+Jacobberger+(architect%2C+1898-1962)&CISOSTART=1,21).

*Researcher/ Organization: Kristen Minor & Brandon J. Grilc/Peter Meijer Architect, PC	Date Recorded: 02/08/2016
---	------------------------------

SHPO #: 31109
