

**CITY OF LAKE OSWEGO
CULTURAL RESOURCES INVENTORY
FIELD FORM 1988-1989**

HIST. NAME: Allen, Dudley, House II"
DATE OF CONSTRUCTION: c. 1940
COMMON NAME:
ORIGINAL USE: Residence
ADDRESS: 1136 Westward Ho Road
OWNER: Ruddy, Tom
PRESENT USE: Residence
ARCH./BLDR.: Unknown
T/R/S: 2S 1E 10BB
TAX LOT: 5300

STYLE: English
Cottage
RESOURCE TYPE:
Building
THEME: Architecture;
Recreation
ADDITION: Forest
Hills
BLOCK:
LOT: 3,4
QUAD: Lake Oswego
LOT SIZE:
ZONE: R-10

PLAN TYPE/SHAPE: Asymmetrical
NO. OF STORIES: 1 1/2
FOUNDATION MATERIAL: Concrete
BASEMENT: Yes
ROOF FORM & MATERIALS: Intersecting gable and hip w/ wood shakes

WALL CONSTRUCTION: Masonry
STRUCTURAL FRAME: Stud
PRIMARY WINDOW TYPE: Metal, multi-light casement
EXTERIOR SURFACING MATERIALS: Rough-troweled stucco; uncoursed stone; staggered butt shingles
DECORATIVE FEATURES: Iron lamp above segmentally arched entrance opening w/ vertical board door w/ mock strap hinges, decorative handle, knocker and grill over window; small round-headed stained glass window, left of front door mock half-timber gable-end, right of front door

OTHER: Secondary entrance set in gabled corner w/ round-headed single-leaf door overlaid w/ wood grid and w/ stained glass light; hip roof dormer; attached hip roof garage w/ paneled, overhead door flanked by lamps; sunroom; massive end wall chimney CONDITION: Good
EXTERIOR ALTERATIONS/ADDITIONS: None apparent
NOTEWORTHY LANDSCAPE FEATURES: Brick paths *and* steps; mature Douglas Firs and ornamental plant materials; rock outcropping at steep slope at rear of property; concrete patio across rear elevation enclosed w/ stone wall w/ brick coping
ASSOCIATED STRUCTURES: None

SETTING: Located on south side of Westward Ho, in an area of early 20th century residences; overlooking Lake Oswego
NOTES:

RECORDER(S): Koler/Morrison, MacDonald DATE: January 1989
SHPO #: _____ FIELD#: _____

CITY OF LAKE OSWEGO CULTURAL RESOURCES INVENTORY

ADDRESS 1136 WESTWARD HO ROAD
TAX MAP/LOT 2S 1E 10BB/5300
SHPO# _____ ROLL/FRAME# _____

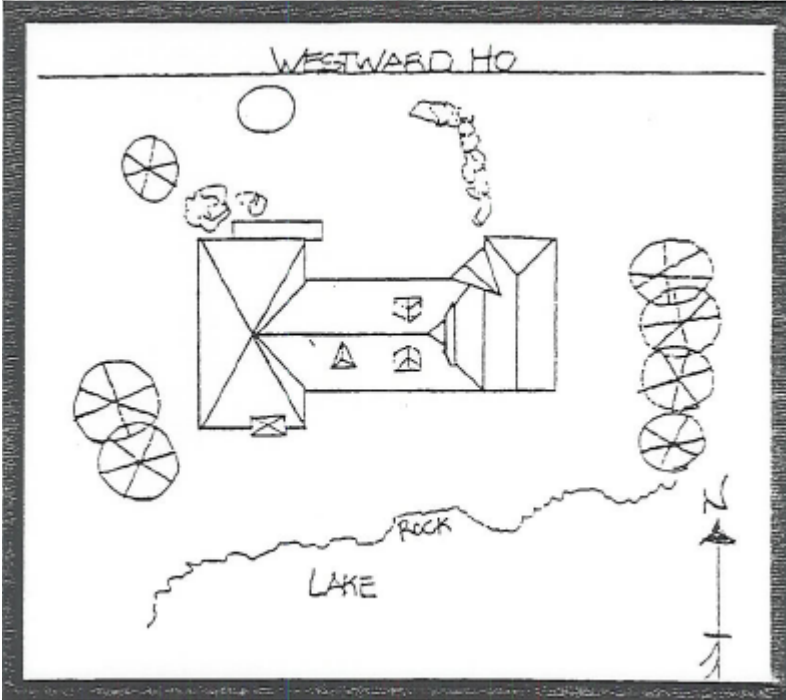

STATEMENT OF SIGNIFICANCE

Address: 1136 Westward Ho Road

Historic Name: Allen, Dudley G., House II

The Allen House is a very good example of the English Cottage style. Tax assessor records indicate that the dwelling was constructed in 1936 at which time it was owned by the Ladd Estate Company, which would seem to suggest that the house was built as a "spec" house. The property was sold to Dudley G. Allen in 1942, six years after the attributed date of construction. The Allens owned, but did not live in the house for more than 20 years. Allen, who worked for the London Lancashire Company, served on the Oswego City Council committee for dog control and was instrumental in drafting a related ordinance. Allen was active in other community organizations, including the Oswego Lake Country Club. Dudley is more closely associated with his principle residence which is also at 1100 Westward Ho Road. (Please see 1100 Westward Ho Road.)

A number of dwellings in the immediate vicinity of the Allen House are designed in rustic styles--including three Richard Sundeleaf designs--similar to the subject building. Designed in the English Cottage tradition the Allen house is clad with rough-troweled stucco with half-timbering, uncoursed stone and staggered butt shingles. The massive, uncoursed stone chimney is also characteristic of the style. Of particular interest is the projecting stone entrance with segmentally arched door opening. The opening is fitted with a vertical plank door enhanced with strap hinges. The hardware is in-keeping with the style.

Stylistic similarities to a house designed by Van Evera Bailey for his brother in Oak Grove near Milwaukie suggest that Bailey may have been the architect for the subject building. According to Bailey's sister, he designing homes in Lake Oswego in the middle 30s.

Bibliography:

Lake Oswego Review, Dudley Allen obituary, 1/12/59.

Ticor Title Company, Oregon City, OR.

Von Schmidt, Frances Fay. Unrecorded interview w/ Jinx'Faulkner, 8/10/89.