

# CITY OF LAKE OSWEGO CULTURAL RESOURCES INVENTORY FIELD FORM 1988-1989

HIST. NAME: Cleary, Colonel A.W., House  
DATE OF CONSTRUCTION: 1937  
COMMON NAME: Drinker House  
ORIGINAL USE: Residence  
ADDRESS: 1139 Westward Ho Road  
OWNER: Mr. & Mrs. Russell Drinker  
PRESENT USE: Residence  
ARCH./BLDR.: Richard Sundeleaf  
T/R/S: 2S 1E 10BB  
TAX LOT: 4100

STYLE: English  
Cottage  
RESOURCE TYPE:  
Building  
THEME: Architecture  
ADDITION: Forest  
Hills  
BLOCK: N/A  
LOT: N/A  
QUAD: Lake Oswego  
LOT SIZE:  
ZONE: R-10

PLAN TYPE/SHAPE: L-plan  
NO. OF STORIES: 2  
FOUNDATION MATERIAL: Concrete  
BASEMENT: Unknown  
ROOF FORM & MATERIALS: Gable with dormer, cedar shingles

WALL CONSTRUCTION: Wood  
STRUCTURAL FRAME: Stud  
PRIMARY WINDOW TYPE: Multi-light casement  
EXTERIOR SURFACING MATERIALS: Stone, cedar shingles  
DECORATIVE FEATURES: Stone chimney, plank door, interior paneling exposed beams

OTHER: None  
CONDITION: Good  
EXTERIOR ALTERATIONS/ADDITIONS:  
NOTEWORTHY LANDSCAPE FEATURES: Rocky site with mature native plants  
ASSOCIATED STRUCTURES: None

SETTING: Located on north side of Westward Ho; in area of early  
to mid 20th century homes large lots near Country Club  
NOTES:

RECORDER(S): Mackenzie, Koler/Morrison DATE: February 1989  
SHPO #: FIELD #:

# CITY OF LAKE OSWEGO CULTURAL RESOURCES INVENTORY

ADDRESS 1139 WESTWARD HO ROAD  
TAX MAP/LOT 2S 1E 10BB/4100  
SHPO# \_\_\_\_\_ ROLL/FRAME# \_\_\_\_\_

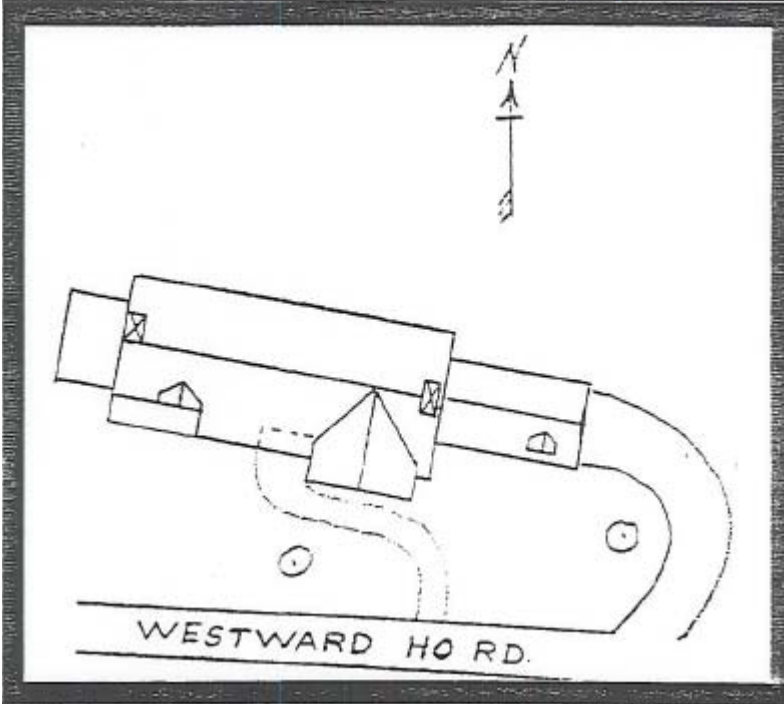

## STATEMENT OF SIGNIFICANCE

Address: 1139 Westward Ho Road  
Historic Name: Cleary, A. W., House

A. W. and Joe Cleary purchased this property in 1931 from the Oregon Iron and Steel Company. They sold it 11 years later to Henry R. and Margaret Drinker. Drinker owned and managed Metzger Parker Insurance Agency, and was one of the first licensed ham radio operators in Oregon. In 1927 he established a record for long distance transmitting on a low wave transmitter. The house remains in the Drinker family today.

The Cleary House is one of three historic properties designed by local architect Richard Sundeleaf on Westward Ho. In the 1930s and 40s Sundeleaf designed many of the noteworthy English Cottage and Tudor Revival houses and commercial buildings seen throughout the study area. The subject building is an excellent illustration of the rustic, medieval cottage type in the use of wood and stone. It is believed to have been constructed in 1936. The massing is representative of many of Sundeleaf's compositions which resembled a village or cluster of buildings. The Cleary House is an excellent and well-preserved example of the type and is significant as such. The informal landscaping treatment enhances the historic character of the house. The Cleary House is important in addition for its contribution to the historic character of the Forest Hills neighborhood.

Bibliography: Clackamas County Directory 1947-1948.  
Drinker, Henry Russell obit., 11/83  
Ticor Title Company, Oregon City, OR.