

**CITY OF LAKE OSWEGO  
CULTURAL RESOURCES INVENTORY  
FIELD FORM 1988-1989**

HIST. NAME: Sacred Heart School  
DATE OF CONSTRUCTION: c. 1925  
COMMON NAME:  
ORIGINAL USE: School  
ADDRESS: 744 First Avenue  
OWNER:  
PRESENT USE: Residence  
ARCH./BLDR.: Unknown  
T/R/S: 2S 1E 3DA  
TAX LOT: 2700

STYLE: Craftsman  
Bungalow  
RESOURCE TYPE:  
Building  
THEME: Architecture;  
Education  
ADDITION: First  
Addition  
BLOCK: 12  
LOT: 2, part 3  
QUAD: Lake Oswego  
LOT SIZE:  
ZONE:

PLAN TYPE/SHAPE: Asymmetrical  
NO. OF STORIES: 1  
FOUNDATION MATERIAL: Concrete; river rock applied to n. elevation  
BASEMENT: Yes  
ROOF FORM & MATERIALS: Intersecting gables w/ composition shingles

WALL CONSTRUCTION: Wood  
STRUCTURAL FRAME: Stud  
PRIMARY WINDOW TYPE: Eight-over-one double hung sash, many in pairs  
EXTERIOR SURFACING MATERIALS: Horizontal siding  
DECORATIVE FEATURES: River rock porch piers and river rock exterior chimney exposed rafters, bargeboards and rustic braces

OTHER: Multi-light paired doors/ multi-light side door; projecting rectangular bay, w. elevation w/ shed roof  
CONDITION: Good  
EXTERIOR ALTERATIONS/ADDITIONS: Multi-light-fixed sash window, w. elevation maybe replacement; corrugated fiberglass over window openings on rear ell, (n.d.)  
NOTEWORTHY LANDSCAPE FEATURES: Mature ornamental plantings; rock garden, rock wall and steps across right-of-way, large bifurcated Douglas Fir tree at steps  
ASSOCIATED STRUCTURES: One-story gabled roof garage w/ lap siding

SETTING: Located on the west side of First Street near the intersection of E avenue; adjacent to Sacred Heart Catholic Church (796 First Avenue); across street from large, medium-density apartment building; area generally characterized by post World War II era residences

NOTES:

RECORDER(S): Koler/Morrisonr MacDonald \_\_\_\_\_  
SHPO #:

DATE: January 1989  
FIELD #:

# CITY OF LAKE OSWEGO CULTURAL RESOURCES INVENTORY

ADDRESS 744 FIRST STREET  
TAX MAP/LOT 2S 1E 3DA/2700  
SHPO# \_\_\_\_\_ ROLL/FRAME# \_\_\_\_\_

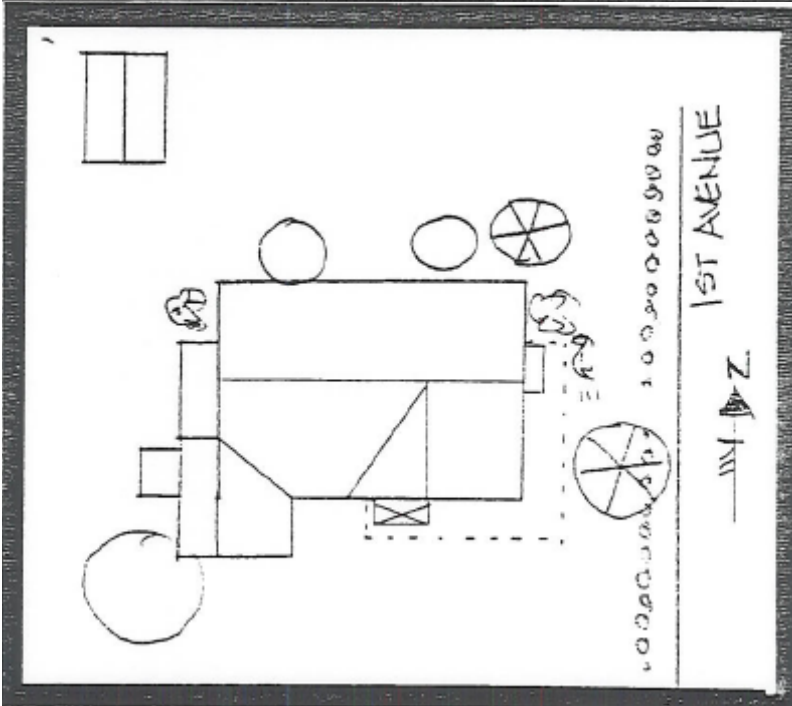

## STATEMENT OF SIGNIFICANCE

Address: 744 First Street

Historic Name: Sacred Heart School Building

This property was first purchased by the Society of the Sisters of the Holy Names of Jesus and Mary from the Oregon Iron and Steel Company in 1892. The deed transferred to the Archdiocese of Oregon City in 1917 in which name it remained for the rest of the historic period.

The Sacred Heart School building is an excellent example of a Craftsman Bungalow; it is therefore significant. Low-pitched gable roofs and deep eaves give the house a ground hugging quality, a hallmark of the style. The river rock porch piers and chimney are particularly distinctive.

Gustav Stickley, a long time advocate of the Craftsman style and editor of the popular "Craftsman" magazine, encouraged the use of natural materials whenever possible. His philosophy grew out of a rejection of the machine-made ornament or fancywork associated with the Victorian era styles. Gustav and his followers replaced the fancywork with a preference for natural materials.

The subject house and associated landscape features are well-preserved and are one of the best examples of the type in the First Addition neighborhood. Located near the northern end of the neighborhood, the building is adjacent to the Sacred Heart Church. (Please see 796 First Street.) There are several post World War II apartment buildings within close proximity.

Bibliography: -----, (current owner). Unrecorded interview w/ J. Morrison, 3/89.  
Ticor Title Company, Oregon City, OR.