

- SITE NOTES**
- SEE WORK FOR THE PROJECT SHALL BE IN ACCORD WITH THE WAREHOUSE USE SPECIFIC PRODUCT OPERATIONS. THE CITY OF LAKE OSWEGO STANDARDS, SPECIFICATIONS, AND REGULATIONS SHALL BE USED AS A MINIMUM. ALL DIMENSIONS SHALL BE AS SHOWN UNLESS OTHERWISE NOTED AS PART OF THESE PLANS. ALL DIMENSIONS SHALL BE TO FACE UNLESS OTHERWISE NOTED.
  - CONTRACTOR SHALL VERIFY ALL DIMENSIONS, PLANS FOR EXISTING CONDITIONS, AND ALL DIMENSIONS, PLANS, AND SPECIFICATIONS SHALL BE TO FACE UNLESS OTHERWISE NOTED.
  - DIMENSIONS SHOWN REFER TO FACE OF CURB, FACE OF BUILDING OR TO THE CENTERLINE UNLESS OTHERWISE NOTED.
  - CONTRACTOR SHALL VERIFY ALL DIMENSIONS, PLANS FOR EXISTING CONDITIONS, AND ALL DIMENSIONS, PLANS, AND SPECIFICATIONS SHALL BE TO FACE UNLESS OTHERWISE NOTED.
  - CONTRACTOR SHALL VERIFY ALL DIMENSIONS, PLANS FOR EXISTING CONDITIONS, AND ALL DIMENSIONS, PLANS, AND SPECIFICATIONS SHALL BE TO FACE UNLESS OTHERWISE NOTED.
  - CONTRACTOR SHALL VERIFY ALL DIMENSIONS, PLANS FOR EXISTING CONDITIONS, AND ALL DIMENSIONS, PLANS, AND SPECIFICATIONS SHALL BE TO FACE UNLESS OTHERWISE NOTED.
  - CONTRACTOR SHALL VERIFY ALL DIMENSIONS, PLANS FOR EXISTING CONDITIONS, AND ALL DIMENSIONS, PLANS, AND SPECIFICATIONS SHALL BE TO FACE UNLESS OTHERWISE NOTED.
  - CONTRACTOR SHALL VERIFY ALL DIMENSIONS, PLANS FOR EXISTING CONDITIONS, AND ALL DIMENSIONS, PLANS, AND SPECIFICATIONS SHALL BE TO FACE UNLESS OTHERWISE NOTED.
  - CONTRACTOR SHALL VERIFY ALL DIMENSIONS, PLANS FOR EXISTING CONDITIONS, AND ALL DIMENSIONS, PLANS, AND SPECIFICATIONS SHALL BE TO FACE UNLESS OTHERWISE NOTED.

**SITE DATA**

**BUILDING DATA**

AREA	42,563 SF
VOLUME	1,217 CB
AREA (PERMANENT)	42,563 SF
AREA (TOTAL)	42,563 SF
AREA (TOTAL)	42,563 SF
AREA (TOTAL)	42,563 SF

**PARKING DATA**

TOTAL OCCUPANCY (NET)	10,000
TOTAL OCCUPANCY (GROSS)	10,000
TOTAL OCCUPANCY (NET)	10,000
TOTAL OCCUPANCY (GROSS)	10,000
TOTAL OCCUPANCY (NET)	10,000
TOTAL OCCUPANCY (GROSS)	10,000

**Walmart** Neighborhood Market  
 1771 JEAN WAY  
 LAKE OSWEGO, OREGON 97035

**PACILAND**  
 1771 JEAN WAY  
 LAKE OSWEGO, OREGON 97035

**SITE PLAN**

**C-10**

**RECEIVED**

FEB 01 2013

CITY OF LAKE OSWEGO

**EXHIBIT E-2**  
**LU 13-0004**



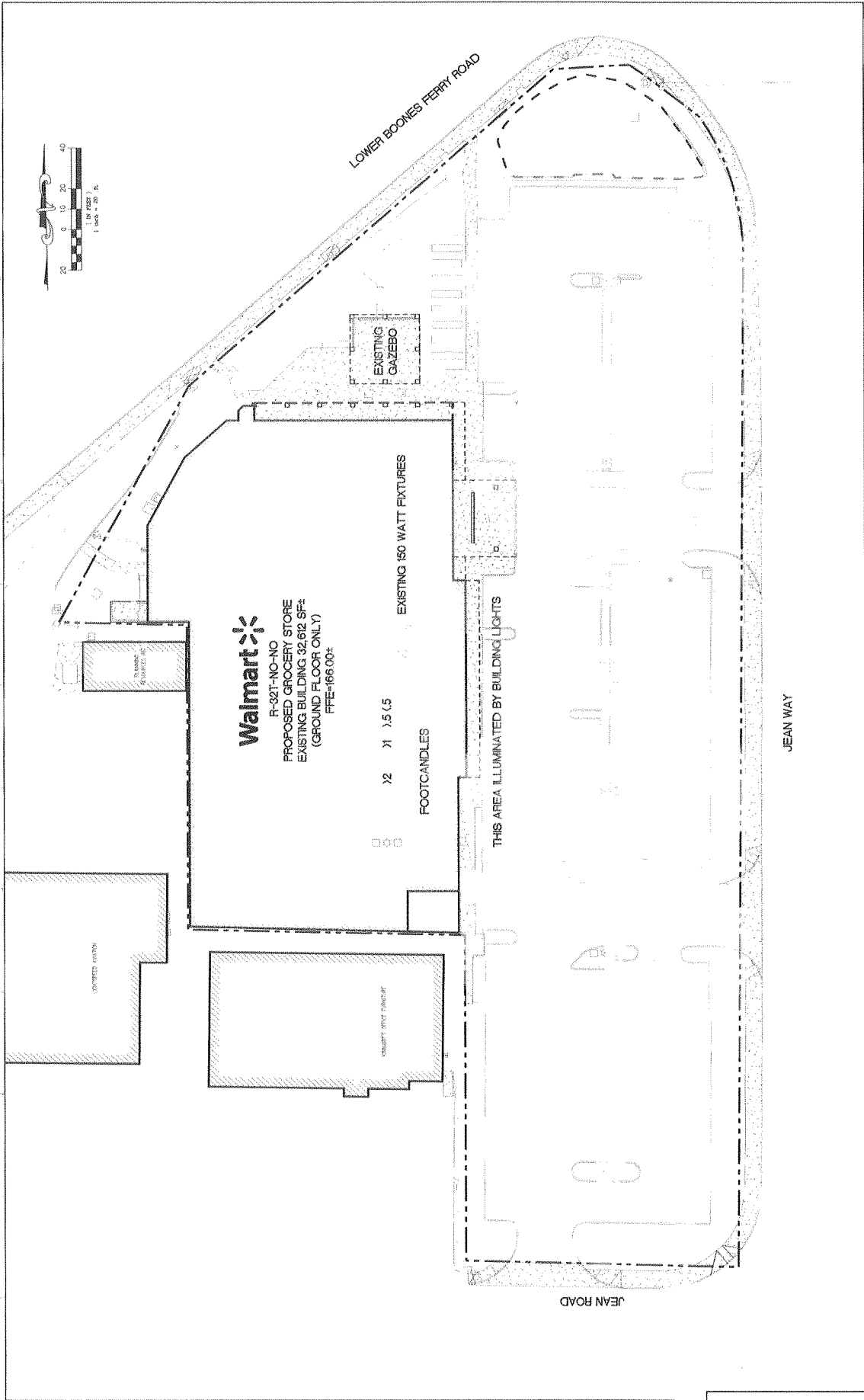

By: \_\_\_\_\_  
 Title: \_\_\_\_\_

Walmart #5995-00  
 Neighborhood Market  
 1771 JEAN WAY  
 LAKE OSWEGO, OREGON 97035

**PAC LAND**  
 5000 NE 17th Street  
 Portland, OR 97223  
 Phone: 503.253.2277  
 Fax: 503.253.2278  
 www.pac-land.com

Designed By: EG  
 Drawn By: EC  
 Issue Date: 1/21/13  
 Issue: MAJOR IMP 105  
 Project No: 20-002-115

By	Revision Description

EXISTING LIGHTING LEVELS EX-A

**EXHIBIT E-4**  
 LU 13-0004

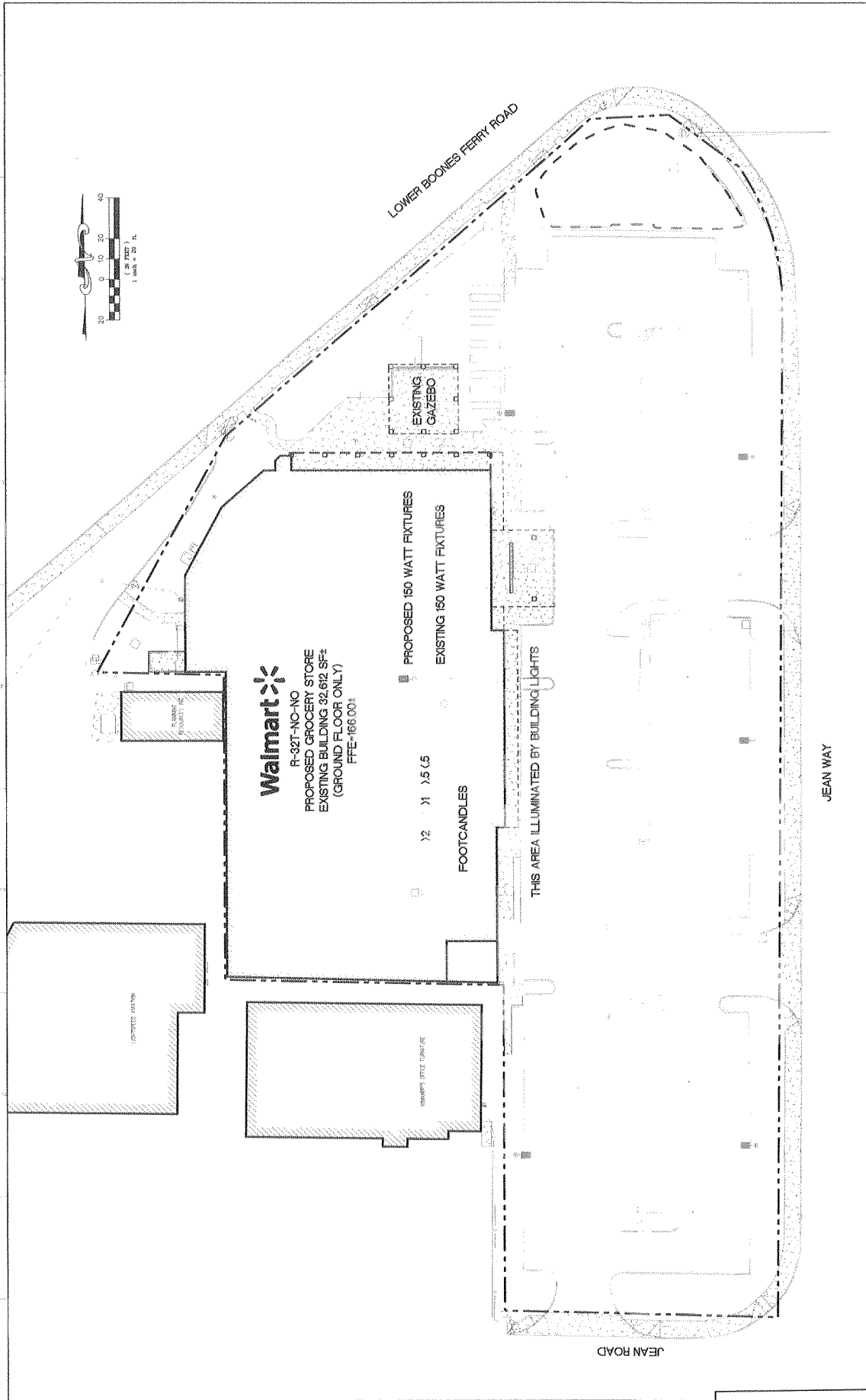

<b>Walmart</b> Neighborhood Market 177N JEAN WAY LAKE OSWEGO, OREGON 97035		#5995-00	C-31
<b>PAC LAND</b> 200 SW 4th Street Portland, OR 97204 Phone: 503.281.2227 Fax: 503.281.2228			
Issue Date: 1/21/13	Designed By: EG		
Issue: AMOR, LAND USE	Drawn By: EG		
Project No.: 201-00-115	Checked By: JR		
Revision Description			

**EXHIBIT E-5**  
 LU 13-0004

