

# Township No 3 South, Range No 1 East, Willamette Meridian, Oregon.

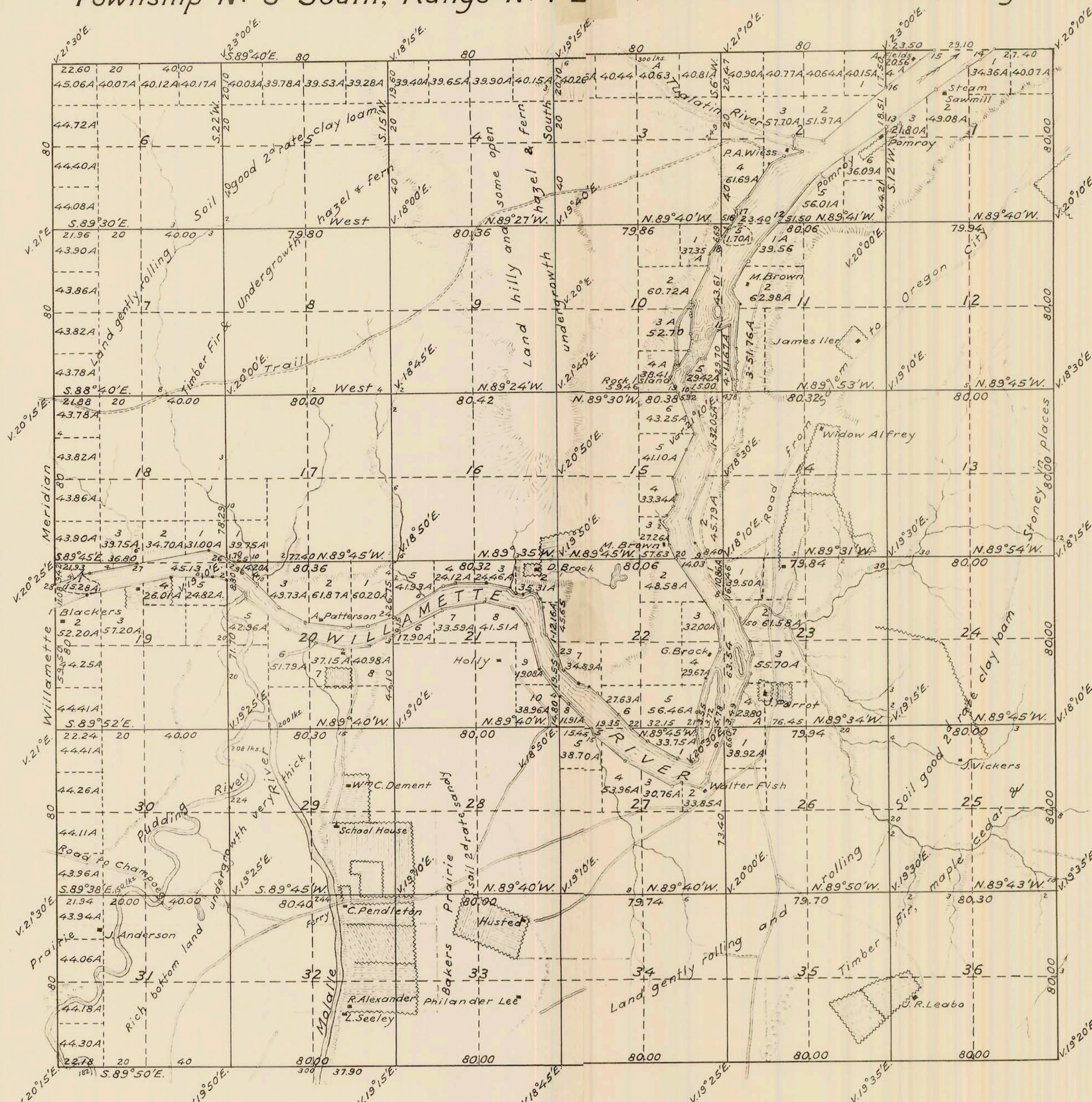

Surveys Designated	By whom Surveyed	Contract		Amount of Surveys			When Surveyed	When charged in the Sur. Genl. Accounts.
		No.	Date	Miles	Chains	Lks.		
Township Lines	Butler Ives	3	August 15th 1851	12	2	18	October 20th 1851	4th Quarter 1851
Subdivisions	Butler Ives	8	October 25th 1851	77	35	20	June 30th 1852	2d Quarter 1852
				2	20	06		3d Quarter 1852

The above Map of Township No. 3 South, of Range No. 1 East, of the Willamette Meridian, Territory of Oregon, is strictly conformable to the field notes of the survey thereof on file in this Office which have been examined and approved.  
 Surveyor General's Office,  
 Oregon City, June 30th, 1852 (signed)

Jno. B. Preston  
 Surv. Genl.

Public Survey Office,  
 Portland, Oregon,  
 November 5, 1929.  
 I certify the above to be correct copy of the original plat on file in this office.  
 Joseph A. Sawoy  
 Office Cadastral Engineer